

Type 84, Zinc

- Wheel balancing weight zinc for almost all steel rims.
- Version with molded spring.
- The wheel weight is equipped with a plastic coating to prevent contact corrosion.
- The wheel weight should only be shortened with special wheel weight pliers with plastic heads.

Application Area

- Universal impact weight for all customary steel rims
- Suitable for french and japanese vehicles as well as light trucks

Hints

- Comparable to Type 161
- Art.-Nr. 82765 (5 g) steelmade featherweight

Technical Data

Type, Weight	BWG 4
Use For Wheel Rim	Steel rim
Use By Vehicle Types	PC
Use By Vehicle Manufacturers	Universal

Title	Weight	Material	PU Piece	Article No.
Balancing Weight Type BWG4	5 g	Steel	100	082765
Balancing Weight	5 g	Zinc	100	113030
Balancing Weight Type BWG4	10 g	Zinc	100	082767
Balancing Weight Type BWG4	15 g	Zinc	100	082768
Balancing Weight Type BWG4	20 g	Zinc	100	082769
Balancing Weight Type BWG4	25 g	Zinc	100	082771
Balancing Weight Type BWG4	30 g	Zinc	100	082774
Balancing Weight Type BWG4	35 g	Zinc	50	082775
Balancing Weight Type BWG4	40 g	Zinc	50	082776
Balancing Weight Type BWG4	45 g	Zinc	50	086439
Balancing Weight Type BWG4	50 g	Zinc	50	086438

AGR: 16.000



INTERNAL/Approved (2019-03-22 22:13:03)

AGW Package Type BWG4 Steel Rims

11

Title	PU Assortment	Article No.
BW PACKAGE FOR STEEL RIMS	1	119128
AGR: 07.905		
Scope Of Supply	Piece	Article No.
Balancing Weight Type BWG4 10 grm	200	082767
Balancing Weight Type BWG4 15 grm	200	082768
Balancing Weight Type BWG4 20 grm	100	082769
Balancing Weight Type BWG4 25 grm	100	082771
Balancing Weight Type BWG4 ´5g	100	113030
ADH.WEIGHTS ST-ZI CAR 60GR	50	-



AGW Package BWG 4

Title	PU Assortment	Article No.
BALANCEW. PACK. BWG 4 CAR ZN	1	209332
AGR: 07.905		
Scope Of Supply	Piece	Article No.
Balancing Weight Type BWG4 ´5g	100	113030
Balancing Weight Type BWG4 10 grm	100	082767
Balancing Weight Type BWG4 15 grm	100	082768
Balancing Weight Type BWG4 20 grm	100	082769
Balancing Weight Type BWG4 25 grm	100	082771
Balancing Weight Type BWG4 30 grm	100	082774
Balancing Weight Type BWG4 35 grm	25	082775
Balancing Weight Type BWG4 40 grm	25	082776



AGW Package BWG4 Adhesive Weight Roll 5kg

Title	PU Assortment	Article No.
BALANCEW. PACK. BWG4 ROLL 5KG	1	209339
AGR: 07.905		
Scope Of Supply	Amount	Article No.
Balancing Weight Type BWG4 15 grm	200	082768
Balancing Weight Type BWG4 25 grm	100	082771
Adhesive Weight Role 5 kg	1	087789
Balancing Weight Type BWG4 10 grm	200	082767
Balancing Weight Type BWG4 20 grm	100	082769
Balancing Weight Type BWG4 '5g	100	113030

Balancing weights type 84

- High spring tension ensures a a good fit, therefore no relocating of the weight possible, even under extreme conditions
- Optimally attachable on the rim, universal and low fit for al stand-ard wheel types

Application Area

- Car impact weight usable for almost all customary steel rims with a horn attachment

Hints

- Only use the Berner balancing weight plier with a plastic cap for installation, Art.-Nr. 022184
- Uncoated, same design as the berners BWG4

Technical Data

Type, Weight	Type 84
Use For Wheel Rim	Steel rim
Use By Vehicle Types	PC
Use By Vehicle Manufacturers	Different manufacturers



Balancing weight

11

Title	Weight	Material	PU Piece	Article No.
Balancing Weight	5 g	Steel	100	209334
Balancing Weight	5 g	Zinc	100	060785
Balancing Weight	10 g	Zinc	100	060786
Balancing Weight	15 g	Zinc	100	060787
Balancing Weight	20 g	Zinc	100	060788
Balancing Weight	25 g	Zinc	100	060789
Balancing Weight	30 g	Zinc	100	060790
Balancing Weight	35 g	Zinc	50	060791
Balancing Weight	40 g	Zinc	50	060792
Balancing Weight	45 g	Zinc	50	060793
Balancing Weight	50 g	Zinc	50	060794

AGR: 16.000

Zinc Balancing Weight BWG5

- Quality
 - Zinc weight with powder coating in silver
- Easy mounting and secure hold
 - Version with molded spring

Application Area

- Universal balancing weight for practically all common European alloy wheels with horn

Hints

- Comparable to type 660

Scope Of Delivery

- Content ZBW package BWG5:
 - 50 x 5 g , 20 g, 25 g, 30 g
 - 100 x 10 g, 15 g

Technical Data

Type, Weight	BWG 5
Use For Wheel Rim	Light alloy rim
Use By Vehicle Types	PC
Use By Vehicle Manufacturers	Universal



Title	Weight	Material	PU Piece	Article No.
Balancing Weight Type BWG5	5 g	Steel	100	082777
Balancing Weight	5 g	Zinc	100	116412
Balancing Weight Type BWG5	10 g	Zinc	100	082778
Balancing Weight Type BWG5	15 g	Zinc	100	082779
Balancing Weight Type BWG5	20 g	Zinc	100	082780
Balancing Weight Type BWG5	25 g	Zinc	100	082781
Balancing Weight Type BWG5	30 g	Zinc	100	082782
Balancing Weight Type BWG5	35 g	Zinc	50	082783
Balancing Weight Type BWG5	40 g	Zinc	50	082784
Balancing Weight Type BWG5	45 g	Zinc	50	086435
Balancing Weight Type BWG5	50 g	Zinc	50	086434

AGR: 16.001

Type 160, zinc

- Wheel balancing weight for thin steel rims (1.5 – 1.8 squared mm thick bead) 13 to 21" rim diameter.
- Used in the original equipment of Opel and Ford.
- Version with molded spring.
- The wheel weight should only be shortened with special wheel weight pliers with plastic heads.

Application Area

- Balancing weight for thin steel rims (1.5 - 1.8 mm rim flange)
- Is used at the original equipment of Opel and Ford
- Comparable with lead weight type 108 or 132

Hints

- 50 g to 60 g with minting "168"

Technical Data

Type, Weight	Type 160
--------------	----------



Balancing weight

Surface protection	Plastic-covered / -coated
Use For Wheel Rim	Steel rim
Use By Vehicle Types	PC
Use By Vehicle Manufacturers	Ford



Title	Weight	Material	PU Piece	Article No.
Car Balancing Weight Type 160	5 g	Zinc	100	000002
Car Balancing Weight Type 160	10 g	Zinc	100	000003
Car Balancing Weight Type 160	15 g	Zinc	100	000004
Car Balancing Weight Type 160	20 g	Zinc	100	000005
Car Balancing Weight Type 160	25 g	Zinc	100	000006
Car Balancing Weight Type 160	30 g	Zinc	100	000007
Car Balancing Weight Type 160	35 g	Zinc	50	000008
Car Balancing Weight Type 160	40 g	Zinc	50	000009
Car Balancing Weight Type 160	45 g	Zinc	50	000010
Car Balancing Weight Type 160	50 g	Zinc	50	000011

AGR: 16.000

Zinc Balancing Weight Type 161

- Universal balancing weight
 - Suitable for rim diameters from 13" to 21"
- Easy mounting and secure hold
 - Version with molded spring
- Prevents contact corrosion
 - Balancing weight with plastic coating

Application Area

- Universal balancing weight for all common european steel rims
- Is used for the original equipment of Toyota

Hints

- Recoiless/low-weight pliers with plastic attachment must be used for mounting.
- If possible, beat the weights with one blow to maintain the tension of the spring.

Technical Data

Type, Weight	Type 161
Surface protection	Plastic-covered / -coated



Use For Wheel Rim	Steel rim
Use By Vehicle Types	PC
Use By Vehicle Manufacturers	Universal Toyota

Title	Weight	Material	PU Piece	Article No.
Balancing Weight Type 161	5 g	Zinc	100	000399
Balancing Weight Type 161	10 g	Zinc	100	000401
Balancing Weight Type 161	15 g	Zinc	100	000402
Balancing Weight Type 161	20 g	Zinc	100	000403
Balancing Weight Type 161	25 g	Zinc	100	000404
Balancing Weight Type 161	30 g	Zinc	100	000405
Balancing Weight Type 161	35 g	Zinc	50	000407
Balancing Weight Type 161	40 g	Zinc	50	000408
Balancing Weight Type 161	45 g	Zinc	50	000409
Balancing Weight Type 161	50 g	Zinc	50	000410
Balancing Weight Type 161	55 g	Zinc	50	000411
Balancing Weight Type 161	60 g	Zinc	50	000412

AGR: 16.000

Type 164, zinc

- Wheel balancing weights for steel rims of French vehicles.
- Version with molded spring.
- The wheel weight is equipped with a plastic coating to prevent contact corrosion.
- The wheel weight should only be shortened with special wheel weight pliers with plastic heads.

Application Area

- Balancing weight for steel rims with a strong convoluted rim flange (B-horn)
- Is used at the original equipment of french vehicles and trucks (with great material strength of the rim) and at Ford Transit and Mercedes Sprinter
- Comparable with lead weight type 107 or 540



Balancing weight

Hints

- Recoilless/low-weight pliers with plastic attachment must be used for mounting.
- If possible, beat the weights with one blow to maintain the tension of the spring.



Technical Data

Type, Weight	Type 164
Surface protection	Plastic-covered / -coated
Use For Wheel Rim	Steel rim
Use By Vehicle Types	PC
Use By Vehicle Manufacturers	French vehicles Ford Mercedes Benz

Title	Weight	Material	PU Piece	Article No.
Balancing Weight Type 164	5 g	Zinc	100	024341
Balancing Weight Type 164	10 g	Zinc	100	024348
Balancing Weight Type 164	15 g	Zinc	100	024349
Balancing Weight Type 164	20 g	Zinc	100	024350
Balancing Weight Type 164	25 g	Zinc	100	024351
Balancing Weight Type 164	30 g	Zinc	100	024352
Balancing Weight Type 164	35 g	Zinc	50	024353
Balancing Weight Type 164	40 g	Zinc	50	024355
Balancing Weight Type 164	45 g	Zinc	50	024356
Balancing Weight Type 164	50 g	Zinc	50	024358

AGR: 16.000

AGW Package BWG5 ZN

Title	PU Assortment	Article No.
BALANCEW. PACK. BWG5 CAR ZN	1	209331

AGR: 07.905

Scope Of Supply	Piece	Article No.
Balancing Weight Type BWG5 5g	100	116412
Balancing Weight Type BWG5 10 gm	100	082778
Balancing Weight Type BWG5 15 gm	100	082779
Balancing Weight Type BWG5 20 gm	100	082780
Balancing Weight Type BWG5 25 gm	100	082781
Balancing Weight Type BWG5 30 gm	100	082782
Balancing Weight Type BWG5 35 gm	25	082783
Balancing Weight Type BWG5 40 gm	25	082784



Adhesive Balancing Weights on Wheels (5 kg) Zinc / Steel

- Ongoing adhesive weight tape with 5g sections
- Individual work due to a practical measuring stripp on the carton packaging
- With connected segments, therefore no cutting edges during cutting
- Quick operation due to practical measuring tape on the paperboard packaging
- Continuous rooll avoids waste
- Easy cutting

Application Area

- For passenger car alloy rims

Characteristics

- Endless adhesive weight with 1000 segments à 5g

Processing Information

- Roller, in the packaging, can be quickly and practically mounted on the bracket

Hints

- Adhesive weight bolt of the galvanized steel roller, part no. 209935, is also available as a locking box, part no. 209336 available
Adhesive weight bolt of the roller steel powdercoated, order no. 087789, is also available as a locking box, part no. 60123 available
Adhesive weight bolt of the roller zinc powdercoated, order no. 087737, is also available as a locking box, part no. 042517 available

Technical Data

Height, Inclusive Adhesive Tape	3.8 mm
Width	19 mm
Use For Wheel Rim	Light alloy rim
Use By Vehicle Types	PC
Use By Vehicle Manufacturers	Universal

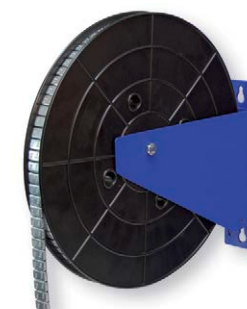

Title	Weight	Material	PU Roll	Article No.
Adhesive Balancing Weights (Roll)	5 kg	Steel	1/3	209335
Adhesive Weight Role	5 kg	Steel	1/3	087789
Adhesive Weight Role	5 kg	Zinc	1/3	087737

AGR: 16.003

Holder for adhesive weight on role

- Suitable for the installation of wall- and workbenches
- Storage near the works space possible
- Appropriate for the installation of 5 kg and 6 kg rolls
- Space-saving through compact design

Processing Information

- The adhesive weight roll should be installed to the halter with the cartonage

Hints

- Holder not included in the shipment

Title	PU Piece	Article No.
ADHESIVE WEIGHT ROLE HOLDER	1	105207

AGR: 16.008



Adhesive Weight Steel

- High-quality steel
- Quality double-sided adhesive tape with a protective foil
- Best adhesive properties and a guaranteed sticking strength
- Flat implementation suitable for vehicles with little space between the caliper and the rim
- Unconnected segments, therefore no cutting edges while detaching

Application Area

- Suitable for almost all customary aluminium rims and alloy wheels

Characteristics

- remarkably shallow design

Processing Information

- 60 g adhesive weight roll separated in 12x5 g sections

Hints

- Product also available as adhesive weight roll with Art.-Nr. 209335

Technical Data

Type, Weight	Type 397U
Surface protection	zinc plated
Height, Inclusive Adhesive Tape	3.8 mm
Number Of Blocks	12 PC
Width	12 mm
Use For Wheel Rim	Light alloy rim
Use By Vehicle Types	PC
Use By Vehicle Manufacturers	Universal

Title	Weight	Length	Material	PU Piece	Article No.
Adhesive Balacing Weight	60 g	19 mm	Steel	100	134876

AGR: 16.003

Vehicle Adhesive Weight Strips Coated with Steel

- High-quality stainless steel
- Impact-resistant powder coating in silver



- Flat design for vehicles with a small area between the brake calliper and rim
- With unconnected segments, therefore no cutting edges during cutting
- Metallic-effect, suitable to the color of the rim
- Quality double-sided adhesive tape with a protective foil
- Best adhesive properties with a guarantees adhesion

Application Area

- For passenger car alloy rims

Characteristics

- Material: Coated steel

Hints

- Article also as adhesive weight roller with Art. 087789 available

Scope Of Delivery

- Content: 300 units

Technical Data

Height, Inclusive Adhesive Tape	3.8 mm
Number Of Blocks	12 PC
Width	19 mm
Use For Wheel Rim	Light alloy rim
Use By Vehicle Types	PC
Use By Vehicle Manufacturers	Universal

Title	Weight	Length	Material	PU Piece	Article No.
Adhesive Balacing Weight	60 g	140 mm	Steel	100	060123

AGR: 16.003

Vehicle Strip Balance Weight layered with Black Steel

- High-quality stainless steel
- Impact-resistant powder coating
- Quality double-sided adhesive tape with a protective foil
- Flat design for vehicles with a small area between the brake calliper and rim
- With unconnected segments, therefore no cutting edges during cutting



Balancing weight

- Best adhesive properties with a guarantees adhesion

Application Area

- Suitable for almost all customary aluminium rims and alloy wheels

Characteristics

- Material: layered black steel

Hints

- 60 g adhesive weight bar divided into 12x5 g sections for cutting off.

Technical Data

Type, Weight	Type 397B
Height, Inclusive Adhesive Tape	3.8 mm
Number Of Blocks	12 PC
Width	19 mm
Use For Wheel Rim	Light alloy rim
Use By Vehicle Types	PC
Use By Vehicle Manufacturers	Universal

Title	Weight	Length	Material	PU Piece	Article No.
Strip Balance Weight SSW FE 60g 3.8mm	60 g	152 mm	Steel	100	060122

AGR: 16.003

Vehicle Self Adhesive Weight Strips

- Flat version for vehicles with little space between the brake caliper and rim
- With unconnected segments, so no cutting edges during separation

Application Area

- For passenger car alloy rims

Hints

- Article as a roll of adhesive tape Art.No. 87737 available

Technical Data

Type, Weight	(Translation missing)
Height, Inclusive Adhesive Tape	3.8 mm
Number Of Blocks	12 PC
Width	19 mm

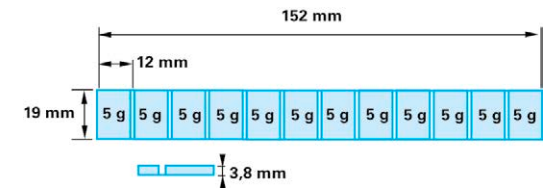

Use For Wheel Rim	Light alloy rim
Use By Vehicle Types	PC
Use By Vehicle Manufacturers	Different manufacturers

Title	Weight	Length	Material	PU Piece	Article No.
Adhesive Weight Strip 60g ZN	60 g	152 mm	Zinc	100	042517

AGR: 16.003

Adhesive balance weight 369 30g

Title	Weight	Material	PU Piece	Article No.
Adhesive balance weight 369 30g	30 g	Zinc	100	343130

AGR: 16.003



Vehicle Self Adhesive Weight Strips 361-5

- For easier adjustment to the rim radius
 - ▶ The 10 g weights have a notch, 30 g weights have two notches, 40 g weights have three notches and 55 g weights have 4 notches - not for cutting!

Application Area

- Universal adhesive weight for light alloy wheel rims
- Flat version for vehicles with a small area available between the disk brake caliper and the rim
- OEM original equipment in the VW-group

Characteristics

- Protruding protective foil for easy removal of foil

Processing Information

- For easy adjustment to the rim's radius the weights over 25 g must be provided with an indentation and from over 45 g with 2 indentations - not to be separated!
- With very small rims heavier weights must be prior to removal of the protective foil adjusted to the wheel's radius using a plastic hammer
- With very large rims, the weight can be formed through impacts on the bag with a plastic hammer prior to installation



INTERNAL/Approved (2019-03-22 22:14:42)

Balancing weight

Hints

- Comparable to lead weight type 325+5

Scope Of Delivery

- 25 x 5 g, 20 g, 25 g, 30 g
- 50 x 10 g, 15 g

Technical Data

Type, Weight	Type 361
Height, Inclusive Adhesive Tape	3.8 mm
Width	19 mm
Use For Wheel Rim	Light alloy rim
Use By Vehicle Types	PC
Use By Vehicle Manufacturers	Volkswagen Volvo Opel / Vauxhall

Title	Weight	Material	PU Piece	Article No.
Adhesive Weight Strip Type 361-5	5 g	Zinc	100	000029
Adhesive Weight Strip Type 361-5	10 g	Zinc	100	000030
Adhesive Weight Strip Type 361-5	15 g	Zinc	100	000031
Adhesive Weight Strip Type 361-5	20 g	Zinc	100	000032
Adhesive Weight Strip Type 361-5	25 g	Zinc	100	000033
Adhesive Weight Strip Type 361-5	30 g	Zinc	100	000034
Adhesive Weight Strip Type 361-5	35 g	Zinc	50	000036
Adhesive Weight Strip Type 361-5	40 g	Zinc	50	000037
Adhesive Weight Strip Type 361-5	45 g	Zinc	50	000038
Adhesive Weight Strip Type 361-5	50 g	Zinc	50	000039
Adhesive Weight Strip Type 361-5	55 g	Zinc	50	000040
Adhesive Weight Strip Type 361-5	60 g	Zinc	50	000041

AGR: 16.003

Zinc Adhesive Weight Type 363

- Can be divided as necessary
- Easy processing
 - Optimal adaptation to the rim radius
- Easy removal of the film
 - Siliconized protective film



- Permanent corrosion resistance and very good appearance
 - Plastic coating
- Speedliner

Application Area

- For passenger car alloy rims

Processing Information

- To divide the segments, use balancing weight tongs or bend them at the desired division point until the zinc bar is cut and then in the opposite direction until the adhesive tape with protective film divides.
- To remove the protective film, press the side of the edge.

Hints

- 45g adhesive weight bar divided into 3x10 g and 3x5 g sections for cutting off.

Technical Data

Type, Weight	Type 363
Height, Inclusive Adhesive Tape	6.1 mm
Width	15 mm
Use For Wheel Rim	Light alloy rim
Use By Vehicle Types	PC
Use By Vehicle Manufacturers	Universal

Title	Weight	Length	Material	PU Piece	Article No.
Adhesive Weight Lock 363-2	45 g	105 mm	Zinc	100	017349

AGR: 16.003

Adhesive Balancing Weight Premium Rolls

- Easy separating: Sticking tape with overhanging protecting film enables fast dissolution - also with gloves possible
- Optimised glue features a higher initial tack and also achieves its maximum final adhesive strength faster
- Easy and clean removing of the weight without aggressive cleaning agent

Application Area

- For passenger car alloy rims



Balancing weight

Characteristics

- Material: zinc and steel plastic coated in black and silver

Processing Information

- Easy mounting of the rolls on item 243565 Speedcut holder

Hints

- Continuous adhesive weight tape with 1000 x 5 g sections.
- Roll can be quickly and conveniently mounted in the packaging on the Speedcut 243656 premium holder.

Technical Data

Type, Weight	Type 356
Surface protection	Plastic-covered / -coated
Height, Inclusive Adhesive Tape	4.8 mm
Width	19 mm
Use For Wheel Rim	Light alloy rim
Use By Vehicle Types	PC

Title	Weight	Material	Color	PU Roll	Article No.
Balancing Weight Premium Zinc black	5 kg	Zinc	black	1	244108
Balancing Weight Premium Zinc silver	5 kg	Zinc	Silver	1	244036

AGR: 16.003



Silver Zinc Weight



Black Zinc Weight

Balancing weight holder Speedcut

- Designed for Premium adhesive weight rolls
- with weight scale for measuring
- fixing on walls or balancing machine possible
- robust and useful design
- easy changing of the blade

Application Area

- Reel seat for premium adhesive weights out of zinc/steel with an incorporated weight scale and an innovative cutting system

Title	PU Piece	Article No.
Balancing weight holder Speedcut	1	243656

AGR: 16.003

Spare Parts	PU Amount	Article No.
Spareblade Speedcut	1	243664

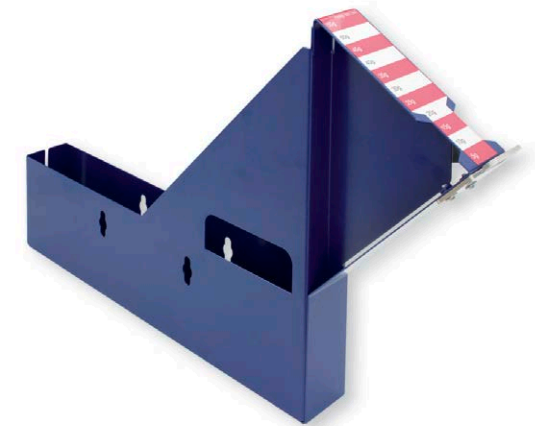

Adhesive Balancing Weight Premium Rolls Steel

- Easy seperating: Sticking tape with overhanging protecting film enables fast dissolution - also with gloves possible
- Optimised glue features a higher initial tack and also achieves its maximum final adhesive strength faster
- Easy and clean removing of the weight without aggressive cleaning agent

Application Area

- For passenger car alloy rims

Characteristics

- Material: steel plastic coated in black and silber

Processing Information

- Easy mounting of the rolls on item 243565 Speedcut holder

Hints

- Continuous adhesive weight tape with 1000 x 5 g sections.
- Roll can be quickly and conveniently mounted in the packaging on the Speedcut 243656 premium holder.



Black Steel Weight



Silver Steel Weight

Balancing weight

Technical Data

Type, Weight	Type 355
Surface protection	Plastic-covered / -coated
Height, Inclusive Adhesive Tape	3.8 mm
Width	19 mm
Use For Wheel Rim	Light alloy rim
Use By Vehicle Types	PC
Use By Vehicle Manufacturers	Universal

Title	Weight	Material	Color	PU Roll	Article No.
Balancing Weight Premium Steel black	5 kg	Steel	black	1	243666
Balancing Weight Premium Steel silber	5 kg	Steel	Silver	1	243667

AGR: 16.003

Adhesive balance weight

Application Area

- For car alloy wheels

Characteristics

- With unconnected segments, thus no cutting edges when cutting off
- Fast working thanks to practical measuring tape on the cardboard packaging

Title	Weight	Material	PU Assortment	Article No.
Adhesive balance weight	5000 g	Steel zinc plated	1	210692

AGR: 16.003



Balancing Weights For Trucks Type 530

- Counterweight for trucks with tubeless tyres
- Suitable for rim sizes from 22.5" to 26.5"
- Universally applicable for tapered shoulders, flat or well-base rims

Application Area

- Balancing weight for small trucks with tubeless tires
- Suitable for rim dimension of 22.50 x 6.75 up to 26.50 x 12.00 inches
- Universally applicable for tapered bead seat, flat or drop centered rims

Hints

- Pursuant to Article 4 (2) (a) of Directive 2000/53 / EC, materials and components of vehicles placed on the market after 1 July 2003 shall not contain lead, mercury, cadmium or hexavalent chromium. Vehicles used are vehicles and light commercial vehicles of categories M1 and N1 as defined in section A of Annex II to Directive 2007/46 / EC:

Class M1: Motor vehicles designed and built for the carriage of passengers with a maximum of eight seats, except the driver's seat.

Class N1: Motor vehicles designed and built for the carriage of goods with a maximum permissible mass of up to 3.5 tonnes.

Only use Berner weight weights with plastic cap
 Recognized with "Pb" (lead)

Technical Data

Type, Weight	Type 530
Use For Wheel Rim	Steel rim
Use By Vehicle Types	CV
Use By Vehicle Manufacturers	Mercedes Benz Scania Volvo Evobus MAN



Balancing weight

11

Title	Weight	Material	PU Piece	Article No.
Balancing Weights For Trucks Type 530	50 g	Lead	10	067377
Balancing Weights For Trucks Type 530	75 g	Lead	10	067393
Balancing Weights For Trucks Type 530	100 g	Lead	10	067814
Balancing Weights For Trucks Type 530	150 g	Lead	10	067822
Balancing Weights For Trucks Type 530	200 g	Lead	10	068101
Balancing Weights For Trucks Type 530	250 g	Lead	10	274127
Balancing Weights For Trucks Type 530	300 g	Lead	10	068110

AGR: 16.004

Balance Powder LKW

- Reduces tire wear
- Significant time saving
- Pulverized balancing material is resistant against moisture in the wheel
- Does not affect the tire carcass
- No restriction of repair or retreading capacity of the wheels
- Excellent flow characteristics and no loss of shape or balance force

Application Area

- Quick and easy balancing of trucks, light trucks and caravan wheels during assamblage

Characteristics

- Balancing powder is working during drive mode, centrifugal force ensures an even distribution of the balancing powder inside the wheel

Scope Of Delivery

- Balancing powder truck granulate 8kg
- 20 velve inserts
- 20 gas-tight sealing caps

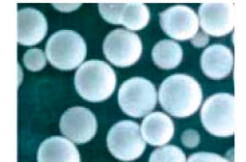
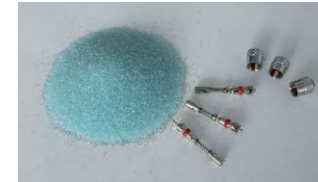

Balancing weight

Technical Data

Type, Weight	BS
Use For Wheel Rim	Steel rim
Use By Vehicle Types	Truck

- DAF
- Honda
- Hummer
- IVECO
- Jeep
- Land Rover
- MAN
- Mitsubishi
- Nissan
- Scania
- Toyota
- Volkswagen
- Volvo

Use By Vehicle Manufacturers



Title	Weight	Material	PU Bucket	Article No.
BALANCE POWDER LKW 8KG	8000 g	Composite material	1	116433

AGR: 16.004

Motorcycle Plug-in Weight Type 713

- Elimination of static imbalance in motorcycle spoke wheels
- Spoke nipple with Ø 6.0 and 6.4 mm
- According to DIN 74 371, polished chrome

Application Area

- Elimination of static imbalance on motorcycle spoked wheels
- Spoked nipple-Ø 6.0 & 6.4 mm

Characteristics

- According to DIN 74 371, polished chrome

Processing Information

- The stack weight is mounted in rim center at the spoke nipple

Hints

- The plug-in weight is attached to the spoke nipple in the middle of the rim.

Technical Data

Type, Weight	Type 713
Use For Wheel Rim	Spoked wheel
Use By Vehicle Types	Motor cycle
Use By Vehicle Manufacturers	Universal

Title	Weight	Material	PU Piece	Article No.
Type 713	10 g	Zinc	25	236772
Type 713	15 g	Zinc	25	236780
Type 713	20 g	Zinc	25	236799

AGR: 16.005

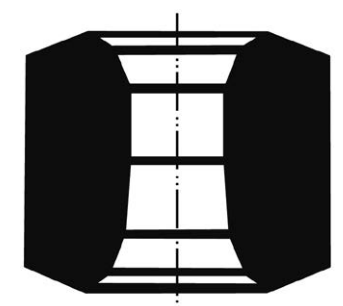
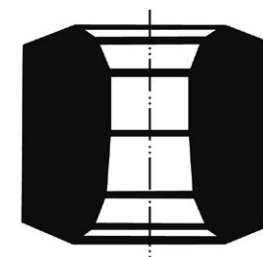

Adhesive Weight with Wheel

11

- Elimination of dynamic imbalance on motorcycle rims
- Very precise balancing
 - ▶ 2.5 g sections
- Prevents the formation of corrosion between lead body and rim
 - ▶ The adhesive tape is water-repellent

Application Area

- Elimination of dynamic imbalance on motorcycle wheels
- 2,5 g separations for pinpoint balancing

Characteristics

- Water-resistant adhesive tape prevents corrosion between lead object and rim

Processing Information

- 50 g adhesive weight roll separated in 7x5 g and 6x2,5 g sections
- The weights should be applied laterally of the rims on the bead seat
- The bonding surface has to be spotless and free of grease

Hints

- 50g adhesive weight bar divided into 7x5g and 6x2.5g sections for cutting off.
- According to Article 4(2)(a) of Directive 2000/53/EC, materials and components of vehicles placed on the market after 1 July 2003 shall not contain lead, mercury, cadmium or chromium VI. The term "vehicles" includes passenger cars and light commercial vehicles of the categories M1 and N1 according to Annex II Section A of European Directive 2007/46/EC:

Class M1:

Motor vehicles designed and constructed for the carriage of passengers and having no more than eight seats in addition to the driver's seat.

Class N1:

Cars designed and constructed for the carriage of goods with a maximum permissible mass of up to 3.5 tons.

- Only use Berner balancing weight pliers with plastic cap for assembly.
- Marked with "Pb" (lead) for recognition.

Technical Data

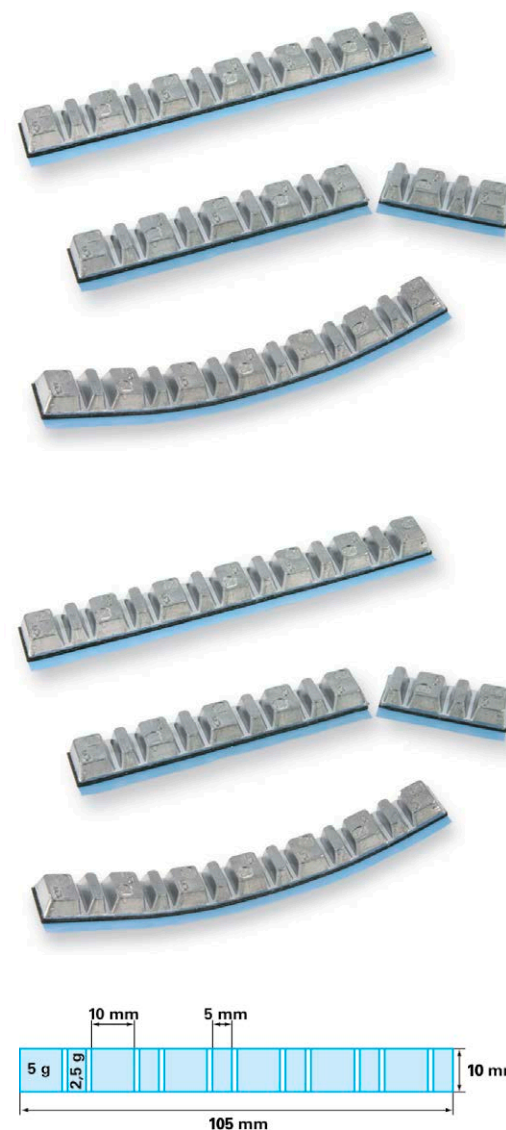

Height, Inclusive Adhesive Tape	7.0 mm
Use For Wheel Rim	Light alloy rim
Use By Vehicle Types	Motor cycle
Use By Vehicle Manufacturers	Universal

Title	Weight	Material	Color	PU Piece	Article No.
Type 715-5	50 g	Lead	Silver	25	171956

AGR: 16.005

Adhesive Weight with Wheel

- Elimination of dynamic imbalance on motorcycle rims
- Very precise balancing
 - ▶ 2.5 g sections
- Prevents the formation of corrosion between lead body and rim
 - ▶ The adhesive tape is water-repellent
- Excellent surface protection
 - ▶ Chrome coating
- Speedliner

Application Area

- Elimination of dynamic imbalance on motorcycle wheels
- 2,5 g separations for pinpoint balancing

Characteristics

- Excellent surface protection through the chrome layer

Processing Information

- 50 g adhesive weight roll seperated in 7x5 g and 6x2,5 g sections
- The weights should be applied laterally of the rims on the bead seat
- The bonding surface has to be spotless and free of grease

Hints

- Highgloss chrome-plated execution of the weight type 715-5

Technical Data

Type, Weight	Type 715-C
Surface protection	chromium plated
Height, Inclusive Adhesive Tape	7.0 mm
Use For Wheel Rim	Light alloy rim
Use By Vehicle Types	Motor cycle

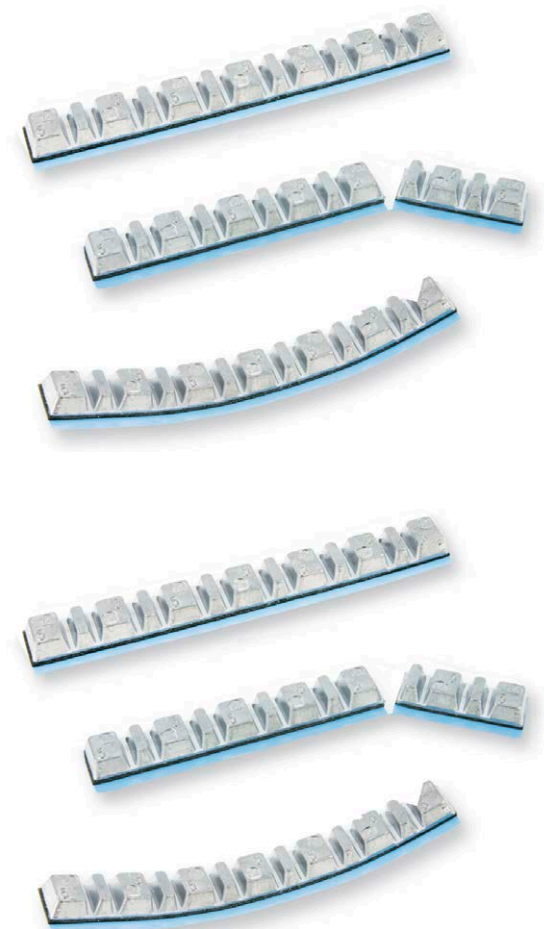

INTERNAL/Approved (2019-03-22 22:15:49)

Balancing weight

Use By Vehicle Manufacturers

Universal

11

Title	Weight	Material	PU Piece	Article No.
Type 716-5	50 g	Lead	25	122340

AGR: 16.005

Adhesive Weight Remover

- Handy, economic and environmentally friendly, as no solvents are needed for the removal of adhesive residues
- Long life thanks to high-quality plastic compound
- Allows unproblematic reworking with a file after long use
- ergonomic handle can be stroked with a hammer and prevents from slipping in case of sticking weights

Application Area

- Fast and gentle disassembly of adhesive weights on light alloy wheels

Characteristics

- Impact-resistant and unbreakable plastic, re-sharpened, can be used in form of cutting, piercing and levering, with bore hole for hanging up

Title	PU Piece	Article No.
Adhesive Weight Remover	1	001529

AGR: 16.008



11

Pincer for Balancing Weights with plastic

Application Area

- For the assembly and disassembly of balancing weights
- Removes hubcaps
- Bends mounting clips
- Specifically for zinc weights

Technical Data

Type, Weight	BA
Use For Wheel Rim	Steel rim
Use By Vehicle Types	PC
Use By Vehicle Manufacturers	Dacia

Title	Material	PU Piece	Article No.
PLIER F.BAL.WEIGH.W.PLAST.	Steel	1	022184

AGR: 16.008



11

Rubber valve TR412

- High quality standard
 - Production according to ETRTO V2.03.6

Application Area

- For tubeless tyres on cars and motorbikes

Processing Information

- Use assembly paste to pull in.

Hints

- Shelf life: rubber valves can be stored for up to 3 years if stored in cool, dry and dark conditions.
- All pressure related values refer to cold tyres.
- The maximum permissible speed for all rubber valves is 210 km/h.

Technical Data

Material Rubber



Title	Length	Tire Pressure, Max	Rim Hole-Ø	PU Piece	Article No.
Rubber Valves TR412 Original Quality	33 mm	4.5 bar	11.3 mm	100	543578
Rubber Valves TR412 Import Quality	33 mm	4.5 bar	11.3 mm	100	106600

AGR: 16.010

Rubber valve TR413

- High quality standard
 - Production according to ETRTO V2.03.1

Application Area

- For tubeless tyres on cars

Processing Information

- Use assembly paste to pull in.

Hints

- Shelf life: rubber valves can be stored for up to 3 years if stored in cool, dry and dark conditions.
- All pressure related values refer to cold tyres.
- The maximum permissible speed for all rubber valves is 210 km/h.

Technical Data

Material Rubber



Title	Length	Tire Pressure, Max	Rim Hole-Ø	PU Piece	Article No.
Rubber Valve TR 413 OEM supplier quality	43 mm	4.5 bar	11.3 mm	100	008028
Rubber Valve TR 413 OE-Quality	43 mm	4.5 bar	11.3 mm	1/100	368808
Rubber Valve TR 413	43 mm	4.5 bar	11.3 mm	100	200825
Rubber Valve TR 413 non OEM quality	43 mm	4.5 bar	11.3 mm	100	104784

AGR: 16.010

Rubber valve TR413, with chrome sleeve

- High quality standard
 - Production according to ETRTO V2.03.1
- Visual enhancement
 - Chrome sleeve

Application Area

- For tubeless tyres on cars

Processing Information

- Use assembly paste to pull in.

Hints

- Shelf life: rubber valves can be stored for up to 3 years if stored in cool, dry and dark conditions.
- All pressure related values refer to cold tyres.
- The maximum permissible speed for all rubber valves is 210 km/h.

Technical Data

Material	Rubber
----------	--------

Title	Length	Tire Pressure, Max	Rim Hole-Ø	PU Piece	Article No.
VALVE TR 413 W.CHROM BUSH 43	43 mm	4.5 bar	11.3 mm	25	115405

AGR: 16.010



Rubber valve TR414

- High quality standard
 - Production according to ETRTO V2.03.2

Application Area

- For tubeless tyres on cars

Processing Information

- Use assembly paste to pull in the valve

Hints

- Durability: Rubber valves can be stored for up to 3 years in cool, dry and dark storage
- All pressures refer to cold tires
- Maximum permissible speed for all rubber valves is 210 km/h

Technical Data



Material	Rubber
Norms	DIN 7780

Title	Length	Tire Pressure, Max	Rim Hole-Ø	PU Piece	Article No.
Rubber Valve TR 414 OEM supplier quality	49 mm	4.5 bar	11.3 mm	100	006785
Rubber Valve TR 414 Standard Quality	49 mm	4.5 bar	11.3 mm	1/100	368809

AGR: 16.010

Rubber Valve TR418 long

- High quality standard
 - Production according to ETRTO V2.03.4

Application Area

- For tubeless tyres on cars

Processing Information

- Use assembly paste to pull in.

Hints

- Shelf life: rubber valves can be stored for up to 3 years if stored in cool, dry and dark conditions.
- All pressure related values refer to cold tyres.
- The maximum permissible speed for all rubber valves is 210 km/h.

Technical Data

Material	Rubber
----------	--------



Title	Length	Tire Pressure, Max	Rim Hole-Ø	PU Piece	Article No.
Rubber valves TR418 Import Quality	61.5 mm	4.5 bar	11.3 mm	100	220450
Rubber valves TR418 Original Quality	61.5 mm	4.5 bar	11.3 mm	100	104785

AGR: 16.010

INTERNAL/Approved (2019-03-22 22:16:27)

Metal valve 2024

- OEM quality

Application Area

- For passenger cars and vans

Technical Data

Material	Brass
Surface protection	Nickel plated
Rim thickness	3 - 12 mm
Tightening torque, min max	4 - 6 Nm



Title	Wrench Width	Length	Tire Pressure, Max	Rim Hole-Ø	PU Piece	Article No.
Metal Valve 2024 Original Equipment Quality	14 mm	42 mm	14 bar	11.3 mm	25	008311

AGR: 16.011

Metal Valve 2024 long

- OEM quality

Application Area

- For passenger cars and vans

Technical Data

Material	Brass
Surface protection	Nickel plated
Rim thickness	3 - 6 mm
Tightening torque, min max	4 - 6 Nm



Title	Wrench Width	Length	Tire Pressure, Max	Rim Hole-Ø	PU Piece	Article No.
Metal Valves 2024 Original Quality	16 mm	42 mm	14 bar	11.3 mm	25	320668

AGR: 16.011

Metal valve 42MS

- OEM quality
- Small wrench size prevents scratches on the rim during assembly and disassembly

Technical Data

Material	Brass
Surface protection	Nickel plated
Rim thickness	3 - 6 mm
Tightening torque, min max	4 - 6 Nm



11

Title	Wrench Width	Length	Tire Pressure, Max	Rim Hole-Ø	PU Piece	Article No.
Rubber Valves 42 MS Original Quality	11 mm	42 mm	14 bar	11.3 mm	25	117813
Metal Valve 42 MS	11 mm	42 mm	20 bar	11.3 mm	1/20	244488

AGR: 16.011

TPMS diagnostic tool

- Universal device for diagnosing, programming and configuration of OE-sensors and virtually all universal sensors - one-time investment for universal use
- Self-explaining menu navigation - Simple, fast and safe operation
- Large, high-resolution colour display (4.3 ") - Large, perfect readable lettering, recognizable even in sunlight
- Constant software updates - Always up to date
- OBDII interface - fast teaching of the sensors to the vehicle electronics (not included at scope of delivery Item No. 216234)
- Printer - fast, process relevant report printing for recording (not included at scope of delivery Item No. 216234)

Hints

- Update: A card in a sealed envelope, which contains the update code, will be delivered. This code has to be entered into the computer program. Thereby the TPMS diagnostic device is unlocked for another year of free updates. It should be noted, that the redemption of cards with a opened or damaged envelope is not possible.

Scope Of Delivery

- Item No. 216235:
- Diagnostic device



brilliant color display



Supplied Art. 216235

Valves and accessories

11

- OBDII interface incl. Cable
- Printer
- Dockingstation
- Charger
- USB cable for PC
- Quick Start user manual
- Transport case
- 1 year free updates
- Item No. 216234:
- As above but without dockingstation and printer

Title	PU Piece	Article No.
Diagnostic tool incl. OBDII	1	216234
AGR: 16.091		
Accessories Available	PU Amount	Article No.
Dockingstation + printer for TPMS diagnostic tool	1	243074
Printer paper for TPMS diagnostic tool	1/10	219380
Update code for TPMS diagnostic tool (1 year)	1	245083

Accessories for TPMS diagnostic tool

Title	PU Piece	Article No.
Dockingstation + printer for TPMS tool	1	243074
Printer paper for TPMS diagnostic tool	1/10	219380
Update code for TPMS tool (1 year)	1	245083

AGR: 16.091



Metal Valve 40 MSF

Application Area

- Plan lowered rims with valve mounting Ø 27 mm
- Rim thickness 3.5 - 6.0 mm

Characteristics

- For rims with plan seated valve receptacle diameter 27 mm

Technical Data

Material	Brass
Surface protection	Brass
Angle	90 °
Tightening torque, min max	25 - 31 Nm



11

Title	Wrench Width	Length	Tire Pressure, Max	Rim Hole-Ø	PU Piece	Article No.
Metal Valve 40 MSF	23 mm	40 mm	14 bar	15.7 mm	1/10	123793

AGR: 16.013

Metal Valves 32 MS/ TR575

Application Area

- Wheels with 15 ° dropped rim center
- Rim thickness 6.0 - 9.0 mm

Characteristics

- For rims with plan seated valve receptacle diameter 27 mm

Technical Data

Material	Brass
Surface protection	Brass
Tightening torque, min max	4 - 6 Nm

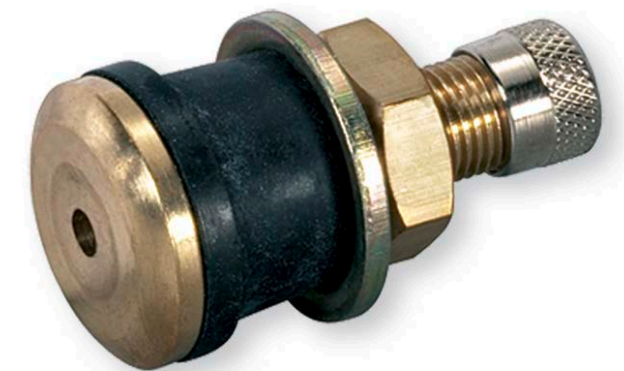

Title	Wrench Width	Length	Tire Pressure, Max	Rim Hole-Ø	PU Piece	Article No.
Metal Valve TR 575	14 mm	33 mm	14 bar	15.7 mm	1/10	123795

AGR: 16.013

INTERNAL/Approved (2019-03-22 22:17:02)

Metal Valves 58 MS

Application Area

- Wheels with 15 ° dropped rim center
- Rim thickness 3.0 – 6.0 mm

Characteristics

- For rims with plan seated valve receptacle diameter 27 mm

Technical Data

Material	Brass
Surface protection	Brass
Angle	45 °
Tightening torque, min max	12 - 15 Nm



Title	Length	Tire Pressure, Max	Rim Hole-Ø	PU Piece	Article No.
Metal Valve 58 MS	58 mm	14 bar	9.7 mm	10	123796

AGR: 16.013

Metal Valves 70 MS

Application Area

- Wheels with 15 ° drop center rim
- Rim thickness from 3.0 to 6.0 mm

Characteristics

- For rims with plan seated valve receptacle diameter 27 mm

Technical Data

Material	Brass
Surface protection	Brass
Angle	27 °
Tightening torque, min max	12 - 15 Nm



Title	Length	Tire Pressure, Max	Rim Hole-Ø	PU Piece	Article No.
METAL VALVE 70MS9.7 TRUCK	70 mm	14 bar	9.7 mm	1/10	123791

AGR: 16.013

Metal Valves 90 MS

Application Area

- Wheels with 15 ° dropped rim center
- Rim thickness 3,0 – 6,0 mm

Technical Data

Material	Brass blank
Surface protection	Brass
Angle	27 °
Tightening torque, min max	12 - 15 Nm



Title	Length	Tire Pressure, Max	Rim Hole-Ø	PU Piece	Article No.
Metal Valves 90 MS	90 mm	14 bar	9.7 mm	1/10	123789

AGR: 16.013

Transporter Valves

11

- Additional sealing
 - Plastic valve cap with seal
- High load carrying capacity
 - Metal valve characteristics
- Labor and time savings
 - Simple hand assembly thanks to rubber valve characteristics
- Reliable sealing
 - Highly flexible sealing lip and optimized sealing contour
- No special tools for disassembly and no rim damage
 - Patented pressure washer with predetermined breaking points
- Universal fit suitable for almost all wheels



Application Area

- Universal valve for high-performance tyre with high tyre pressures, high average speeds and high temperatures
- Especially for commercial vehicles, light trucks and RVs

Characteristics

- Temperature resistance: -40 ° C to +130 ° C
- Valve hole size: 11.3 +0.4 mm
- Burst pressure: 15 bar

Technical Data

Material	Metal Rubber
Temperature resistance	-40 °C - +130 °C
Burst Pressure	15 bar

Title	Length	Tire Pressure, Max	Rim Hole-Ø	PU Piece	Article No.
METAL VALVE CVV40	40 mm	7 bar	11.3 mm	25	061650
METAL VALVE CVV47	47 mm	7 bar	11.3 mm	25	061649

AGR: 16.013

Metal valves

- Adjustable mounting angle from 0 ° to 40 ° - Perfect fit in almost all rims
- Exclusive mounting concept - Mounted within seconds with just one tool (torque wrench)
- Metal valve - Maximum security, also above 210 km/h
- Alminum with anodized coating - Durable protection against corrosion

Application Area

- For the use with Berner Universal Sensor

Characteristics

- Surface: anodized coating
- Cover cap with metal valve silver: plastic
- Cover cap with metal valve black: metal

Processing Information

- The valve must be replaced at each sensor and tire change
- Note the two-stage tightening of the cap nut:
- Level 1 = Tear-off

Scope Of Delivery

- Square-head bolt
- Valve Body
- Cap nut
- Dust protection cap

Technical Data

Material	Aluminium
Tightening torque, min max	4

Title	Wrench Width	Length	Tire Pressure, Max	Rim Hole-Ø	PU Piece	Article No.
Valve 43mm black f. uni-sensor	11 mm	43 mm	8 bar	11.3 mm	10	216036
Valve 43mm silver f. uni-sensor	11 mm	43 mm	8 bar	11.3 mm	10	216037

AGR: 16.091



TPMS Tool Kit

11

- The complete solution for a professional mounting of tire pressure sensors
- Professional installation and service at the most common TPMS systems
- Two calibrated torque wrenches with different accommodations for precise tightening
- Torque wrench in T-handle version for more feeling when tightening
- Avoid overspeeding of union nuts and valve-cores
- Appropriate extra slim torx inserts
- No damage of the rim
- Packed in a suitcase with foam

Application Area

- Perfect set for the professional installation and removal of TPMS systems

Scope Of Delivery

- 2 x torque wrench
- 1 x valve inserting tool
- 3 x tx bit 1/4" impulse
- 2 x socket wrench
- 1 x extension
- 1 x backing device
- 1 x valve tapering tool
- Transport box



Title	PU Piece	Article No.
TPMS Tool Kit	1	219157

AGR: 03.419

Valve Insert

Title	PU Piece	Article No.
Valve Insert 0045 Short	25	009180

AGR: 16.014



Secure Spring Clamp

Application Area

- Flexible valve extensions

Title	PU Piece	Article No.
Secure Spring Clamp	1	115406

AGR: 16.014



Stiff Valve Extensions

Application Area

- Commercial vehicle tire valves

Characteristics

- Plastic model (POM)

Technical Data

Material	Polyacetal POM
----------	----------------

Title	Length	PU Piece	Article No.
Stiff Valve Extensions	115 mm	1/10	123800
Stiff Valve Extensions	150 mm	1/10	123801
Stiff Valve Extensions	170 mm	1/10	123802

AGR: 16.014



Valve Wrench

Application Area

- Fitting and removing of valves

Hints

- Art. No. 215085 has a holding function for the valve insert valve insert stays on the holder after unscrewing



Title	PU Piece	Article No.
VALVE SCREWDRIVER WITH HOLDER	1	215085

AGR: 16.014

Dust Cap

Application Area

- For car valves

Characteristics

- PVC without rubber gasket

Hints

- The green valve cap is mainly used for nitrogen filled tyres identification.
- Caps without rubber gasket



Technical Data

Material	PVC
----------	-----

Title	Color	PU Piece	Article No.
Dust Cap	Green	100	151031
Dust Cap	black	25	009172

AGR: 16.014

Flexible Valve Extension

Application Area

- Commercial vehicle tire valves

Technical Data

Material Steel

Title	Length	PU Piece	Article No.
Flexible Valve Extension	105 mm	1/10	110375
Flexible Valve Extension	125 mm	1/10	110374
Flexible Valve Extension	140 mm	1/10	110373
Flexible Valve Extension	180 mm	1/10	110372
Flexible Valve Extension	210 mm	1/10	110371

AGR: 16.014

Valve mounting

Title	PU Piece	Article No.
VALVE PULLING-IN LEVER 8308	1	011100

AGR: 16.014



Plastic Retractable Valve Lever

Application Area

- Gentle rim valve assembly, not just for alloy wheels

Characteristics

- Stable plastic lever

Technical Data

Material	Plastic	
----------	---------	--

Title	PU Piece	Article No.
Plastic Retractable Valve Lever	1	017355

AGR: 16.014



Valve thread repair tool 4in1

- Unscrew valve cap
- Unscrew valve
- Remove any foreign bodies from the valve channel.
- Trim valve thread in valve channel
- 4 functions in one tool

Application Area

- To repair damaged threads on tire valves
- For unscrewing the valve cap and unscrewing the valve

Title	PU Piece	Article No.
Valve thread repair tool	1	366688

AGR: 03.419

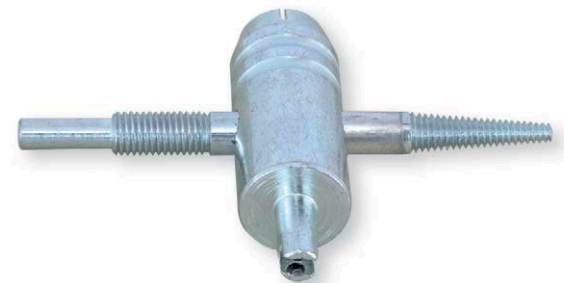

T-Fittings

Technical Data

Material Brass

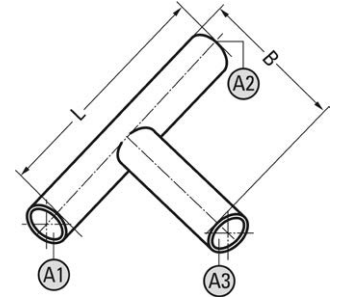
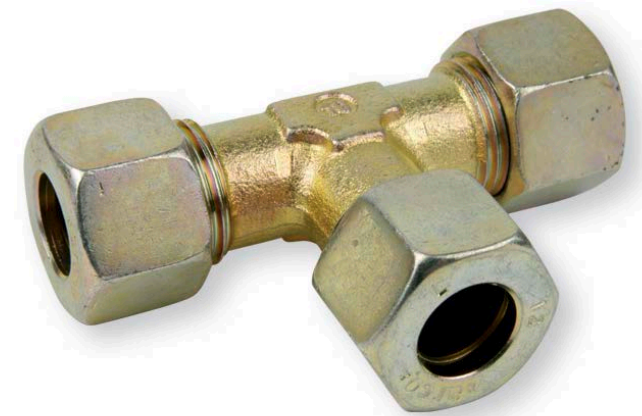

Title	Thread A1 internal	Thread A1 external	PU Piece	Article No.
T-Fittings	6 mm	M 12 x 1.5 mm	5	112043
T-Fittings	8 mm	M 14 x 1.5 mm	5	112044
T-Fittings	10 mm	M 16 x 1.5 mm	5	112045
T-Fittings	12 mm	M 18 x 1.5 mm	5	112047

AGR: 16.940

INTERNAL/Approved (2019-03-22 22:18:12)

Straight Screw Connection

Technical Data

Material

Brass

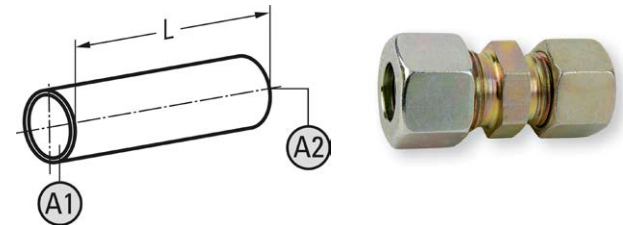
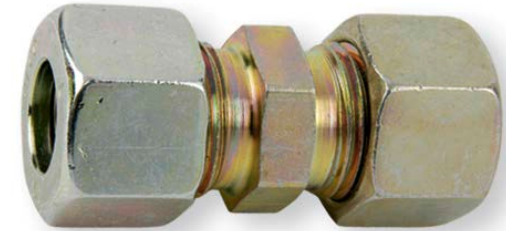

Title	Connection 1, Internal-Ø	Thread A1 external	Connection 2, Internal-Ø	Thread A2 external	PU Piece	Article No.
Screw Connection	6 mm	M 12 x 1.5 mm	6 mm	M 12 x 1.5 mm	5	111958
Screw Connection	8 mm	M 14 x 1.5 mm	6 mm	M 12 x 1.5 mm	5	111960
Screw Connection	8 mm	M 14 x 1.5 mm	8 mm	M 14 x 1.5 mm	5	111959
Screw Connection	10 mm	M 16 x 1.5 mm	10 mm	M 16 x 1.5 mm	5	111962
Screw Connection	12 mm	M 18 x 1.5 mm	10 mm	M 16 x 1.5 mm	5	111964
Screw Connection	12 mm	M 18 x 1.5 mm	12 mm	M 18 x 1.5 mm	5	111963
Screw Connection	15 mm	M 22 x 1.5 mm	15 mm	M 22 x 1.5 mm	5	111965

AGR: 16.940

Elbow Screw-in Union

Technical Data

Material Brass

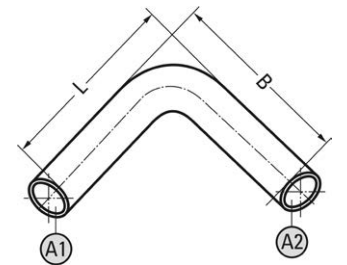
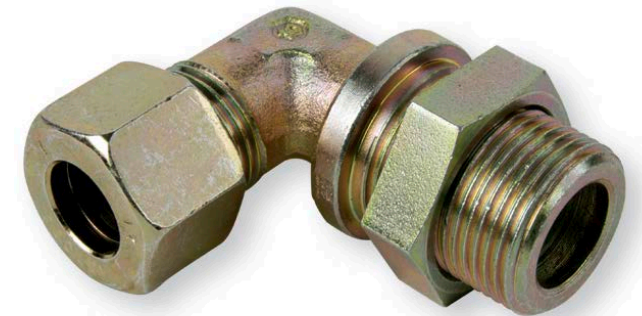

Title	Connection 1, Internal-Ø	Thread A1 external	Thread A2 external	Wrench Width	PU Piece	Article No.
Elbow Screw-in Union	10 mm	M 16 x 1.5 mm	M 16 x 1.5 mm	22 mm	5	111974
Elbow Screw-in Union	12 mm	M 18 x 1.5 mm	M 16 x 1.5 mm	22 mm	5	111975
Elbow Screw-in Union	12 mm	M 18 x 1.5 mm	M 22 x 1.5 mm	27 mm	5	111976
Elbow Screw-in Union	15 mm	M 22 x 1.5 mm	M 22 x 1.5 mm	27 mm	5	111977

AGR: 16.940

Elbow Union

Technical Data

Material

Brass

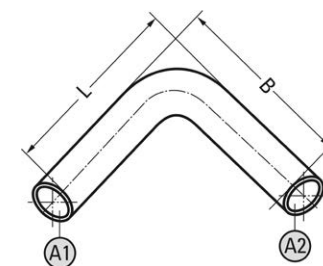

Title	Connection 1, Internal-Ø	Thread A1 external	Connection 2, Internal-Ø	Thread A2 external	PU Piece	Article No.
Elbow Union	6 mm	M 12 x 1.5 mm	6 mm	M 12 x 1.5 mm	5	111969
Elbow Union	8 mm	M 14 x 1.5 mm	8 mm	M 14 x 1.5 mm	5	111971
Elbow Union	10 mm	M 16 x 1.5 mm	10 mm	M 16 x 1.5 mm	5	111972
Elbow Union	12 mm	M 18 x 1.5 mm	12 mm	M 18 x 1.5 mm	5	111973

AGR: 16.940

Bulkhead Fitting

Technical Data

Material Brass

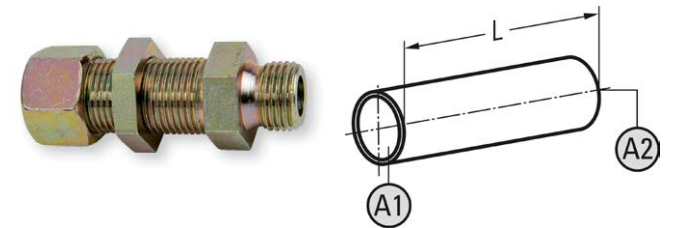
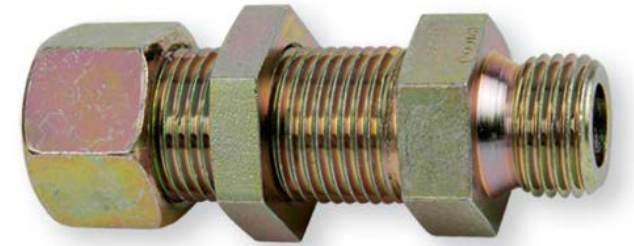

11

Title	Connection 1, Internal-Ø	Thread A1 external	Thread A2 external	Wrench Width	PU Piece	Article No.
Bulkhead Fitting	12 mm	M 18 x 1.5 mm	M 16 x 1.5 mm	24 mm	5	111966
Bulkhead Fitting	12 mm	M 18 x 1.5 mm	M 22 x 1.5 mm	27 mm	5	111967
Bulkhead Fitting	15 mm	M 22 x 1.5 mm	M 22 x 1.5 mm	27 mm	5	111968

AGR: 16.940

11 Test Connector With Internal Brass Screw Thread

Technical Data

Material Brass

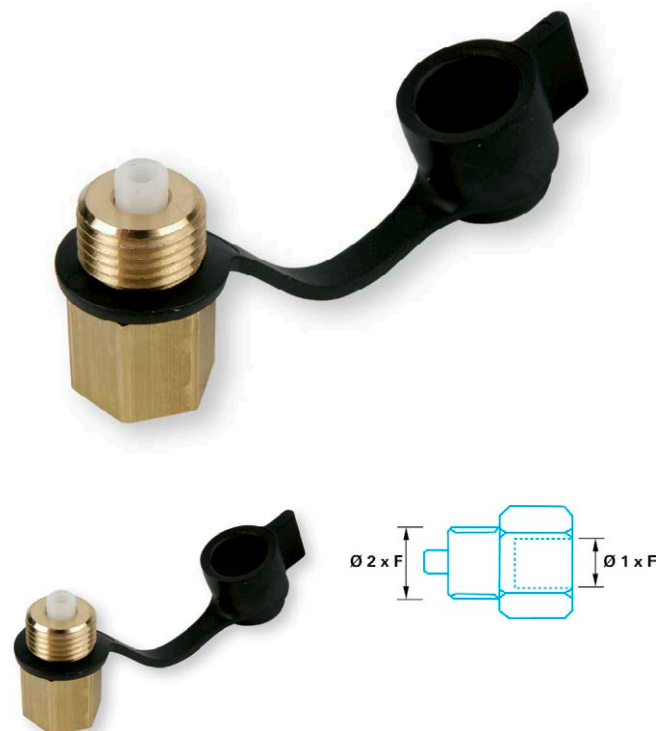

Title	Thread A1 internal	Thread A2 external	Wrench Width	PU Piece	Article No.
TEST CONNECTOR BRASS M12X1,5 AGR: 16.940	M 12 x 1.5 mm	M 16 x 1.5 mm	17 mm	5	111983

Test Connector With External Brass Screw Thread 2

Characteristics

- Connection A2 with sieve insert

Technical Data

Material Brass

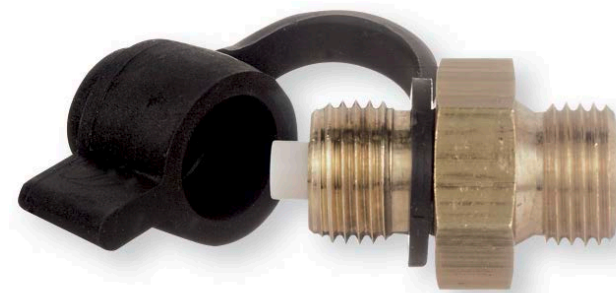

Title	Thread A1 external	Thread A2 external	Wrench Width	PU Piece	Article No.
Test connector	M 16 x 1.5 mm	M 16 x 1.5 mm	22 mm	5	112007
Test connector	M 22 x 1.5 mm	M 16 x 1.5 mm	27 mm	5	112037

AGR: 16.940

Reducing Adapters

Technical Data

Material Steel

11

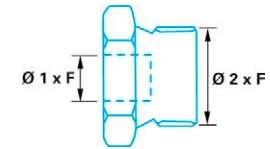
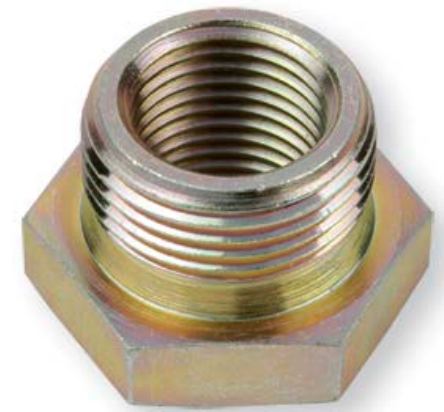

Title	Thread A2 external	Thread A2 internal	Wrench Width	PU Piece	Article No.
Reducing Adapters	M 22 x 1.5 mm	M 16 x 1.5 mm	27 mm	10	111981

AGR: 16.940

Reducing Adapters 2

Technical Data

Material Brass

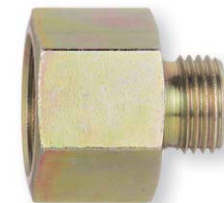

Title	Thread A1 internal	Thread A2 external	Wrench Width	PU Piece	Article No.
Reducing Adapters	M 22 x 1.5 mm	M 16 x 1.5 mm	27 mm	10	111982

AGR: 16.940

Hose Nipple With Screw Thread

Technical Data

Material Steel zinc plated

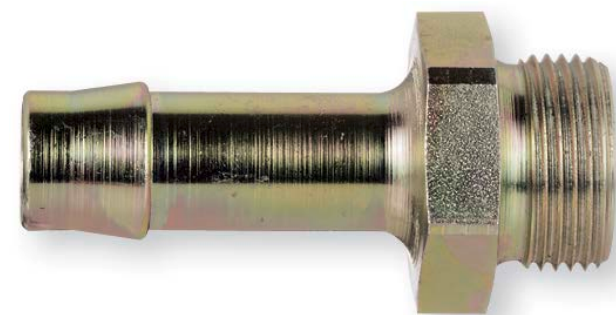

Title	Connection 1, Outside-Ø	Thread A2 external	Wrench Width	PU Piece	Article No.
Hose Nipple With Screw Thread	11 mm	M 16 x 1.5 mm	22 mm	5	112000
Hose Nipple With Screw Thread	11 mm	M 22 x 1.5 mm	27 mm	5	112001
Hose Nipple With Screw Thread	13 mm	M 16 x 1.5 mm	22 mm	5	112002
Hose Nipple With Screw Thread	13 mm	M 22 x 1.5 mm	27 mm	5	112004

AGR: 16.940

INTERNAL/Approved (2019-03-22 22:19:10)

Brass Drainage Valve

Technical Data

Material Brass

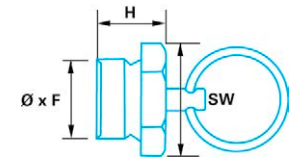
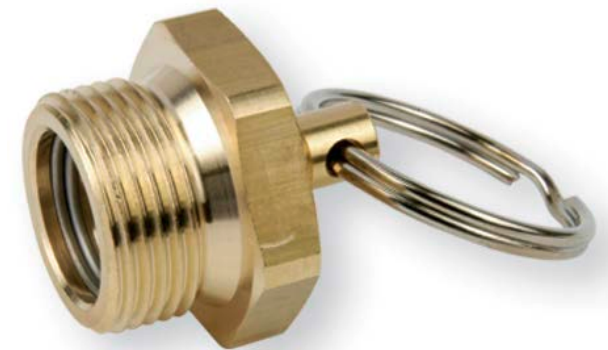

11

Title	Thread A1 external	Length / Height	Wrench Width	PU Piece	Article No.
Brass Drainage Valve AGR: 16.940	M 22 x 1.5 mm	16.5 mm	27 mm	5	111990

Brass Support Sleeves

11



Title	Connection1, pipe	PU Piece	Article No.
Brass Support Sleeves	6 x 1	25	112078
Brass Support Sleeves	8 x 1	25	112079
Brass Support Sleeves	10 x 1	25	112080
Brass Support Sleeves	12 x 1.5	25	112081
Brass Support Sleeves	15 x 1.5	25	112082

AGR: 16.940

Counter nut

Technical Data

Material Brass



Title	Thread A1 internal	Length / Height	Wrench Width	PU Piece	Article No.
Counter-nut	M 16 x 1.5 mm	6 mm	22 mm	25	112086
Counter-nut	M 18 x 1.5 mm	6 mm	24 mm	25	112087
Counter-nut	M 22 x 1.5 mm	8 mm	27 mm	25	112088

AGR: 16.940

INTERNAL/Approved (2019-03-22 22:19:23)

Lock Nut

Technical Data

Material Brass



11

Title	Diameter Internal	Thread A1 internal	Length / Height	Wrench Width	PU Piece	Article No.
Lock Nut	6 mm	M 12 x 1.5 mm	14.5 mm	14 mm	25	112090
Lock Nut	8 mm	M 14 x 1.5 mm	14.5 mm	17 mm	25	112091
Lock Nut	10 mm	M 16 x 1.5 mm	15.5 mm	19 mm	25	112092
Lock Nut	12 mm	M 18 x 1.5 mm	15.5 mm	22 mm	25	112093
Lock Nut	15 mm	M 22 x 1.5 mm	17 mm	27 mm	25	112094

AGR: 16.940

Sealing rings

Application Area

- Line-Ø 15 mm

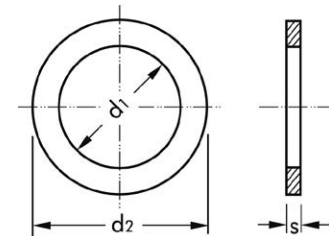

Title	Internal Ø	External Ø	Thickness material	PU Piece	Article No.
Sealing ring	12 mm	19 mm	1.5 mm	25	111993

AGR: 16.940

Pressure Ring

Characteristics

- Connection: diameter 15mm

Technical Data

Material	Brass
----------	-------



Title	Diameter Internal	PU Piece	Article No.
Pressure Ring	15 mm	25	111992

AGR: 16.940

Cutting Ring

Technical Data

Material Steel



11

Title	Diameter Internal	PU Piece	Article No.
Cutting Ring	6 mm	25	112073
Cutting Ring	8 mm	25	112074
Cutting Ring	10 mm	25	112075
Cutting Ring	12 mm	25	112076
Cutting Ring	15 mm	25	112077

AGR: 16.940

Filling Adapter

Application Area

- Filling of brake systems after repair via the workshop compressed air system
- Systems made by Wabco, Bosch and Grau



Title	PU Piece	Article No.
Filling adapter kit for brake systems	1	165015*

* = The delivery time is 21 days

AGR: 16.945

INTERNAL/Approved (2019-03-22 22:19:50)

Screwed Insert

Technical Data

Material Brass

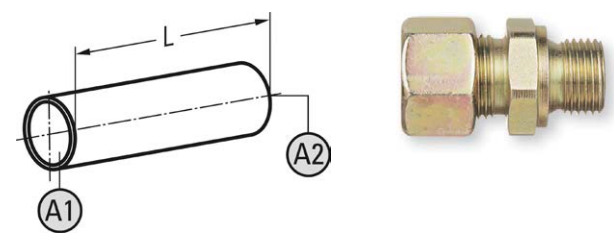
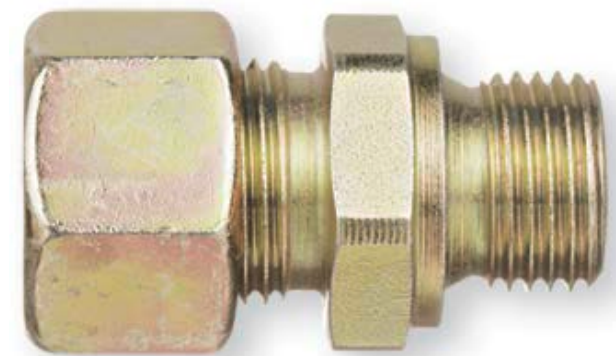

Title	Connection 1, Internal-Ø	Thread A1 external	Thread A2 external	Wrench Width	PU Piece	Article No.
Screwed Insert	6 mm	M 16 x 1.5 mm	M 16 x 1.5 mm	22 mm	5	111950
Screwed Insert	8 mm	M 12 x 1.5 mm	M 12 x 1.5 mm	17 mm	5	111946
Screwed Insert	8 mm	M 16 x 1.5 mm	M 16 x 1.5 mm	22 mm	5	111952
Screwed Insert	10 mm	M 16 x 1.5 mm	M 22 x 1.5 mm	27 mm	5	111955
Screwed Insert	12 mm	M 18 x 1.5 mm	M 16 x 1.5 mm	22 mm	5	111947
Screwed Insert	12 mm	M 18 x 1.5 mm	M 22 x 1.5 mm	27 mm	5	111956

AGR: 16.940

Straight Plug-in Connectors

Technical Data

Material Brass

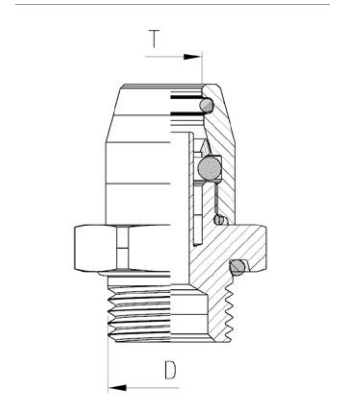

Title	T	D	PU Piece	Article No.
Plug-in Connector	6x1	M10x1	5	112099
Plug-in Connector	10x1	M12x1.5	5	112111
Plug-in Connector	10x1.25	M16x1.5	5	112117
Plug-in Connector	10x1.5	M16x1.5	5	134993
Plug-in Connector	15x1.5	M16x1.5	5	112125

AGR: 16.941

ABC New Line Push-in Coupling

- Easy to disconnect with the special tools.

Technical Data

Material Brass

Operating Pressure, Max. 12.5 bar

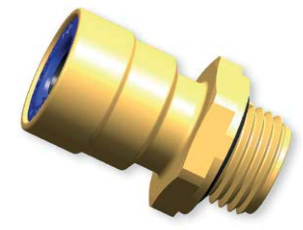
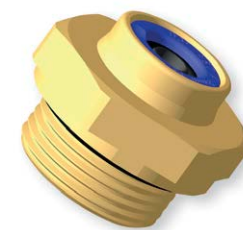

Version 2

Version 1

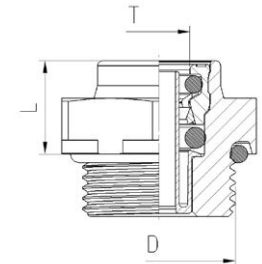
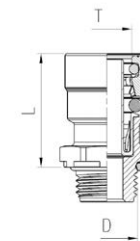

Compressed air brake systems

11

Title	T	D	L	Version	Weight	PU Piece	Article No.
Push-in Coupling	6x1	M12x1,5	23 mm	1	25 g	5	136738
Push-in Coupling	6x1	M16x1,5	12 mm	2	29 g	5	136860
Push-in Coupling	8x1	M12x1,5	25 mm	1	28 g	5	136861
Push-in Coupling	8x1	M16x1,5	17 mm	1	30 g	5	136862
Push-in Coupling	8x1	M22x1,5	13 mm	2	52 g	5	136863
Push-in Coupling	10x1	M12x1,5	29 mm	1	34 g	5	136864
Push-in Coupling	10x1	M16x1,5	28 mm	1	41 g	5	136865
Push-in Coupling	10x1	M22x1,5	20 mm	2	56 g	5	136866
Push-in Coupling	12x1,5	M12x1,5	30 mm	1	39 g	5	136868
Push-in Coupling	12x1,5	M16x1,5	30 mm	1	43 g	5	136869
Push-in Coupling	12x1,5	M22x1,5	19 mm	2	50 g	5	136870
Push-in Coupling	16x2	M16x1,5	33 mm	1	62 g	5	136871
Push-in Coupling	16x2	M22x1,5	30 mm	1	66 g	5	136872

AGR: 16.941

Tube connectors

Technical Data

Material Brass

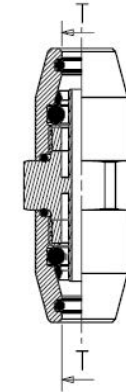

11

Title	T	PU Piece	Article No.
Pipe Connector	6x1	5	112126
Pipe Connector	8x1	5	112128
Pipe Connector	10x1	5	112129
Pipe Connector	10x1.25	5	112130
Pipe Connector	10x1.5	5	112131
Pipe Connector	12x1.5	5	112132
Pipe Connector	15x1.5	5	112133
TUBE PLUG CONNECTOR Ø16X2,0	16x2	5	144732
TUBE PLUG CONNECTOR Ø18X2,0	18x2	5	024166

AGR: 16.941

P5 Connecting Flange

Technical Data

Material Brass

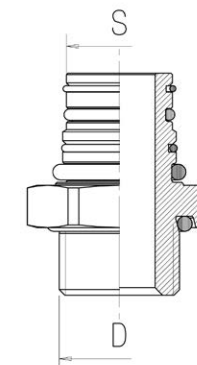

Title	S	D	PU Piece	Article No.
Connecting Flange	P5	M12x1.5	5	134616
PLUG P5, M14X1,5	P5	M14x1.5	5	134617
Connecting Flange	P5	M16x1.5	5	134618
Connecting Flange	P5	M22x1.5	5	134620

AGR: 16.941

90° Angle

Technical Data

Material Brass

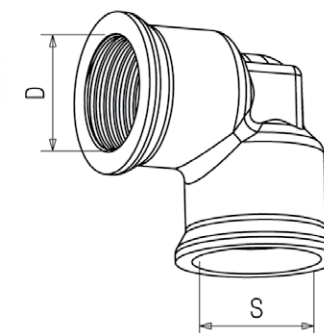

Title	S	D	PU Piece	Article No.
90° Angle	P5	M16x1.5	5	134626

AGR: 16.941

45° Angle with P5 Connection

Technical Data

Material Brass



11

Title	S	D	PU Piece	Article No.
45° Angle P5	P5	M16x1.5	5	121552

AGR: 16.941

T-Flange

Technical Data

Material Brass

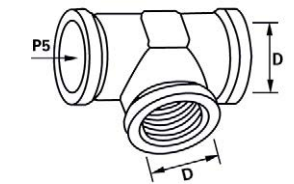

Title	S	D	PU Piece	Article No.
T-Flange	P5	M16x1.5	5	134624

AGR: 16.941

T-Flange

Technical Data

Material Brass

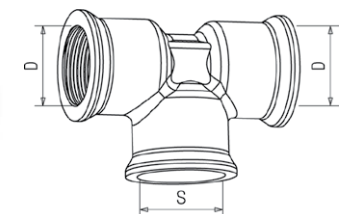

Title	S	D	PU Piece	Article No.
T-Flange	P5	M16x1.5	5	134622

AGR: 16.941

INTERNAL/Approved (2019-03-22 22:21:06)

T-Flange

Technical Data

Material Brass

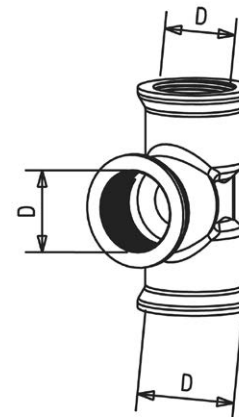

Title	D	PU Piece	Article No.
T-Flange	M16x1.5	5	112202

AGR: 16.941

T-Fixing

Technical Data

Material Brass

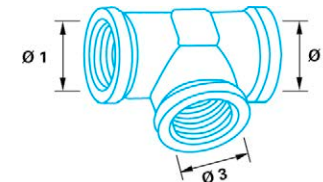

Title	Internal-Ø (ALL)	PU Piece	Article No.
T-Fixing	M 16 x 1.5	5	112204

AGR: 16.941

INTERNAL/Approved (2019-03-22 22:21:12)

Angle Connector

Technical Data

Material Brass

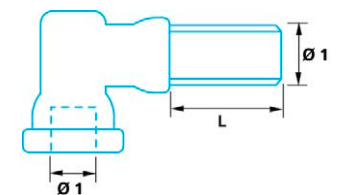
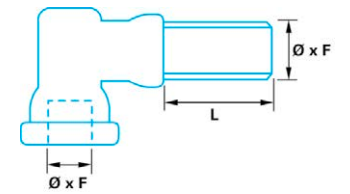
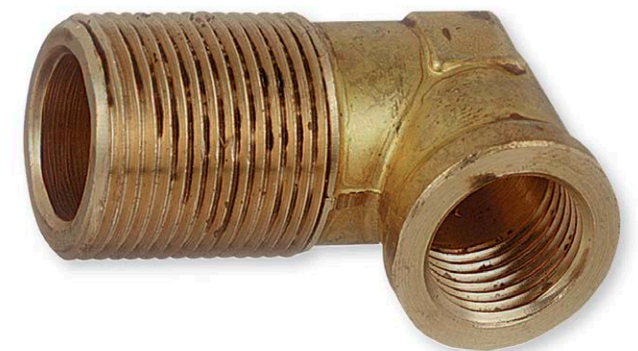

Title	Thread A1 internal	Thread A2 external	Connection 2, Length External Thread	PU Piece	Article No.
ELBOW BULKH.CON.L18 2X(M12X1,5	M 12 x 1.5 mm	M 12 x 1.5 mm	18 mm	5	112172
ELBOW BULKH.CON.L22 2X(M16X1,5	M 16 x 1.5 mm	M 16 x 1.5 mm	22 mm	5	112173
ELB.CON.L20M22X1,5/2X(M16X1,5)	M 16 x 1.5 mm	M 22 x 1.5 mm	20 mm	5	112174

AGR: 16.941

INTERNAL/Approved (2019-03-22 22:21:26)

Bulkhead Connector with Threads

Technical Data

Material Brass

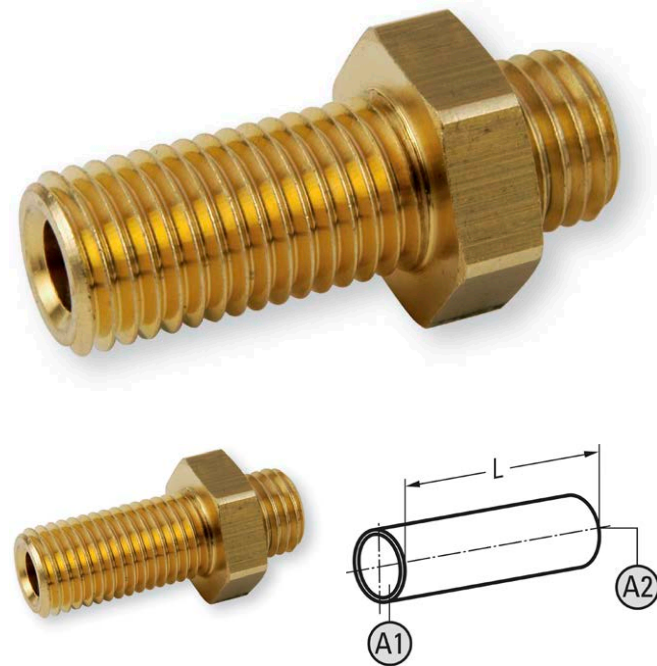

Title	Thread A1 external	Thread A2 external	Connection 1, Length External Thread	Wrench Width	PU Piece	Article No.
Bulkhead Connector	M 12 x 1.5 mm	M 12 x 1.5 mm	24 mm	18 mm	5	112145
Bulkhead Connector	M 16 x 1.5 mm	M 16 x 1.5 mm	24 mm	22 mm	5	112146

AGR: 16.941

Bulkhead Connector with Threads

Technical Data

Material Brass

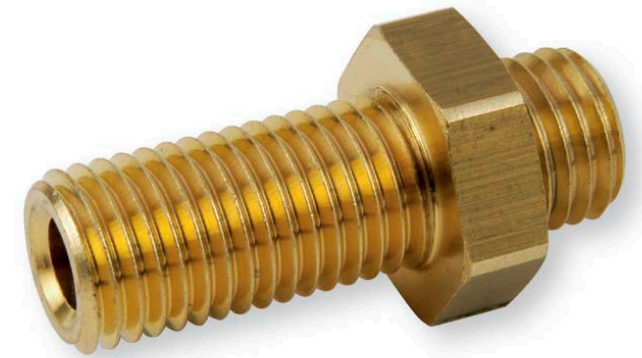

11

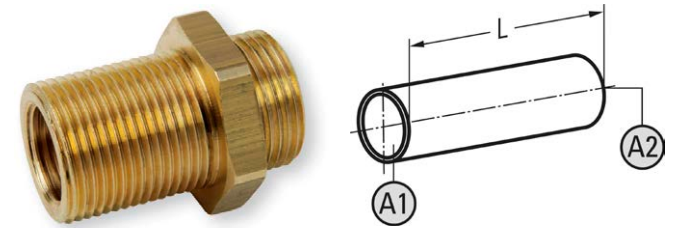

Title	Thread A1 external	Thread A2 internal	Thread A3 external	Connection 1, Length External Thread	Wrench Width	PU Piece	Article No.
Bulkhead Connector	M 22 x 1.5 mm	M 16 x 1.5 mm	M 16 x 1.5 mm	24 mm	28 mm	5	112150
Bulkhead Connector	M 22 x 1.5 mm	M 16 x 1.5 mm	M 22 x 1.5 mm	24 mm	28 mm	5	112149

AGR: 16.941

Bulkhead Connector

Technical Data

Material

Brass

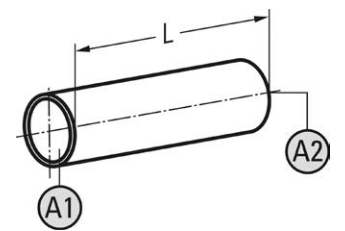

Title	Thread A2 internal	Thread A1 external	Connection 1, Length External Thread	Wrench Width	PU Piece	Article No.
BULKH.CON. L20(M16X1,5/M10X1,0)	M 10 x 1	M 16 x 1.5 mm	20 mm	22 mm	5	112155
BULKH.CON. L24(M22X1,5/M16X1,5)	M 16 x 1.5	M 22 x 1.5 mm	24 mm	28 mm	5	112148
BULKH.CON. L35(M16X1,5/M10X1,0)	M 10 x 1	M 16 x 1.5 mm	35 mm	22 mm	5	112156

AGR: 16.941

Bulkhead Connector with Cone

Technical Data

Material Brass

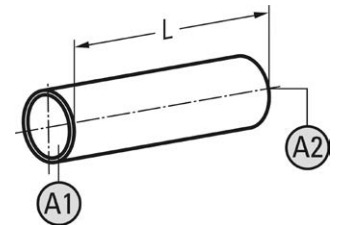
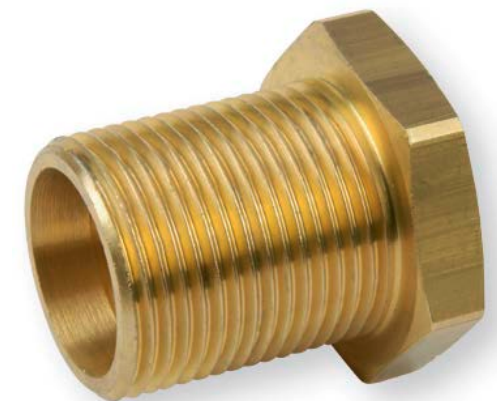
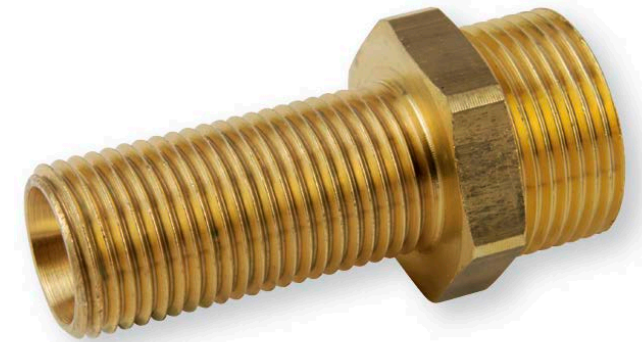

INTERNAL/Approved (2019-03-22 22:21:57)

Title	Connector 1, Inner Cone	Thread A1 external	Connection 1, Length External Thread	Thread A2 internal	Wrench Width	PU Piece	Article No.
Bulkhead Connector	24 °	M 22 x 1.5 mm	24 mm	M 16 x 1.5	28 mm	5	112147

AGR: 16.941

Bulkhead Connector

Technical Data

Material

Brass

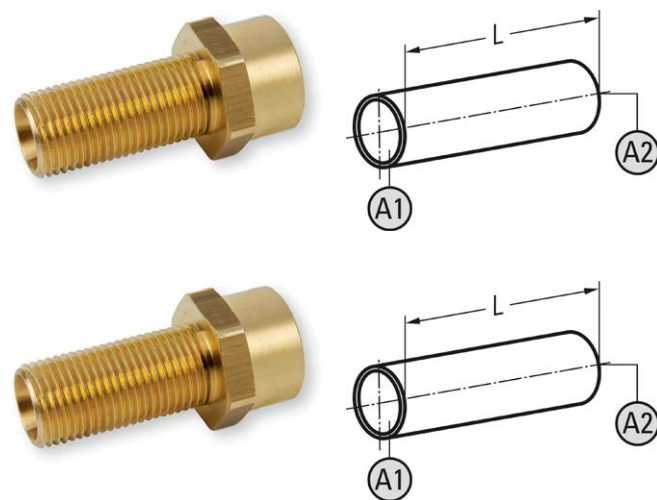
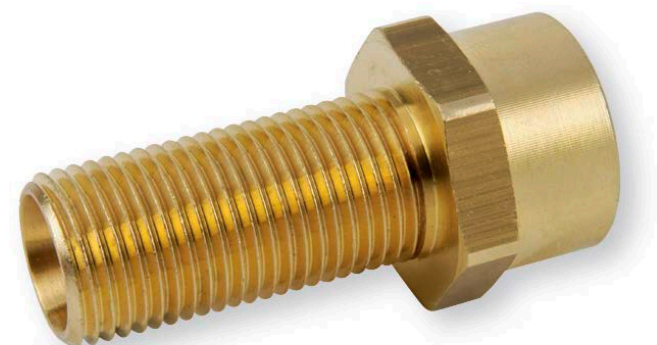

Title	Connector 1, Inner Cone	Thread A1 external	Connection 1, Length External Thread	Thread A2 internal	Connection 2, Length External Thread	Wrench Width
Bulkhead Connector	24 °	M 16 x 1.5 mm	34 mm	M 16 x 1.5	11 mm	24 mm

PU Piece	Article No.
5	112152

AGR: 16.941

Bulkhead Connector L34(M16/22/16)X1,5

Hints

- Item 112152 was in the terminal A2 outside no thread. The terminal has an outside diameter of 22.5mm

Technical Data

Material Brass

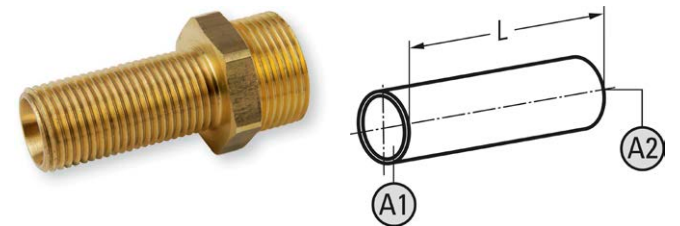
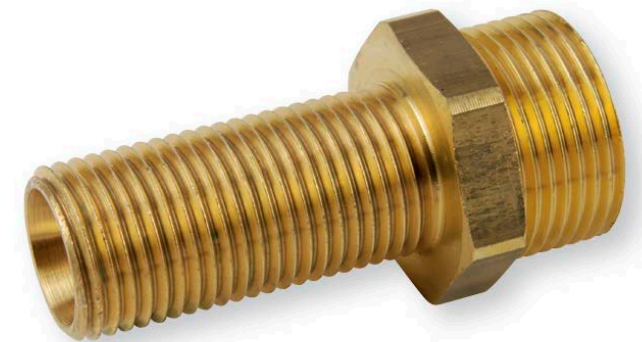

Title	Connector 1, Inner Cone	Thread A1 external	Connection 1, Length External Thread	Thread A2 internal	Thread A2 external
Bulkhead Connector	24 °	M 16 x 1.5 mm	34 mm	M 16 x 1.5	M 22 x 1.5 mm
Connection 2, Length External Thread			Wrench Width	PU Piece	Article No.
11 mm			24 mm	5	112154

AGR: 16.941

Angle

Technical Data

Material Brass

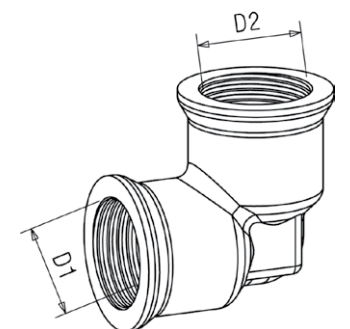

Title	D1	D2	PU Piece	Article No.
90° Angle P 5	M16x1.5	M16x1.5	5	112195

AGR: 16.941

INTERNAL/Approved (2019-03-22 22:22:11)

Test Connector With External Brass Screw Thread

Characteristics

- Connection A2 with sieve insert

Technical Data

Material

Brass

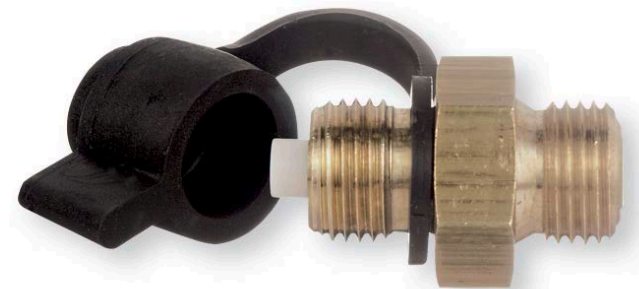

Title	Thread A1 external	Thread A2 external	Wrench Width	PU Piece	Article No.
Testing Connector	M 16 x 1.5 mm	M 16 x 1.5 mm	22 mm	5	112167
Testing Connector	M 16 x 1.5 mm	M 22 x 1.5 mm	28 mm	5	112168

AGR: 16.941

Protection Cap for Testing Valves

Technical Data

Material Rubber



11

Title	PU Piece	Article No.
Protection Cap for Testing Valves	5	112211

AGR: 16.941

Plug

Technical Data

Material Brass

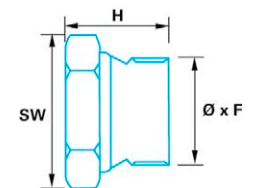

Title	Length / Height	Thread A2 external	Wrench Width	PU Piece	Article No.
Plug	15 mm	M 16 x 1.5 mm	22 mm	5	112170
Plug	15 mm	M 22 x 1.5 mm	28 mm	5	112171

AGR: 16.941

INTERNAL/Approved (2019-03-22 22:22:26)

Lock nut with O-Ring

Technical Data

Material Brass

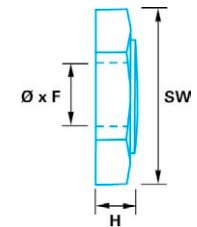

Title	Thread A2 external	Length / Height	Wrench Width	PU Piece	Article No.
Lock nut with O-Ring	M 12 x 1.5 mm	7 mm	18 mm	10	112161
Lock nut with O-Ring	M 16 x 1.5 mm	7 mm	22 mm	10	112162
Lock nut with O-Ring	M 22 x 1.5 mm	7 mm	28 mm	10	112163

AGR: 16.941

Lock Nut

Technical Data

Material Brass

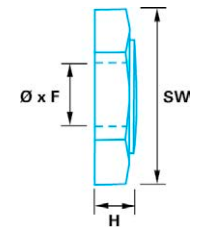

11

Title	Thread A2 external	Length / Height	Wrench Width	PU Piece	Article No.
Lock Nut	M 16 x 1.5	6 mm	22 mm	10	112164
Lock Nut	M 22 x 1.5	6 mm	28 mm	10	112166

AGR: 16.941

Connector / screw connection (compressed air brake installation)

Technical Data

Material Brass

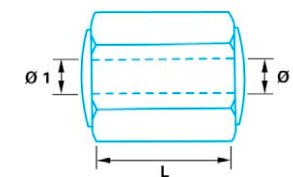

Title	Connection 1, Length External Thread	Thread A1 internal	PU Piece	Article No.
Threaded coupling	19 mm	M 16 x 1.5 mm	5	112158
Threaded coupling	19 mm	M 22 x 1.5 mm	5	112159

AGR: 16.941

INTERNAL/Approved (2019-03-22 22:22:41)

Hose Nipple with Screw Thread (Length + Ø According to DIN)

Technical Data

Material Brass

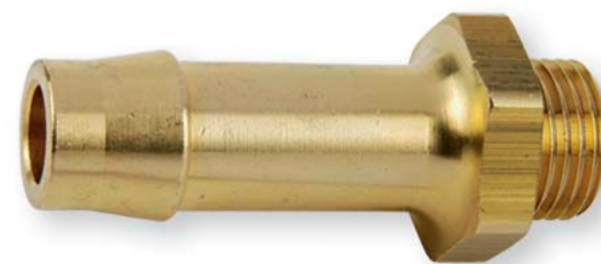

Title	Connection 1, Outside-Ø	Thread A2 external	Length / Height	Wrench Width	PU Piece	Article No.
Hose Connection With Screw Thread	11 mm	M 16 x 1.5 mm	40 mm	22 mm	5	112218
Hose Connection With Screw Thread	11 mm	M 22 x 1.5 mm	40 mm	28 mm	5	112221
Hose Connection With Screw Thread	13 mm	M 16 x 1.5 mm	40 mm	22 mm	5	112219
Hose Connection With Screw Thread	13 mm	M 22 x 1.5 mm	40 mm	28 mm	5	112220

AGR: 16.941

ABC Rotolock

Application Area

- To prevent the ABC connector from rotating

Technical Data

Material PA12 GF50

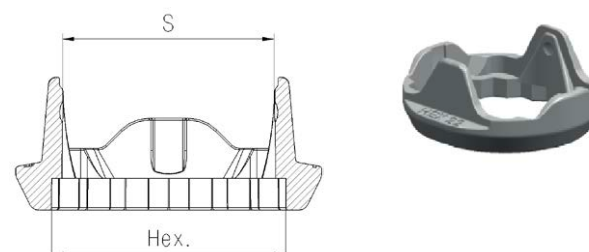

Title	S	HEX	Weight	PU Piece	Article No.
ABC Rotolock	Regular	18	3 g	5	136956
ABC Rotolock	Regular	22	3 g	5	136957
ABC Rotolock	Regular	28	3 g	5	136958
ABC Rotolock	Heavy Duty	22	5 g	5	136959
ABC Rotolock	Heavy Duty	28	4 g	5	136960

AGR: 16.941

ABC Treadless Test Point

Technical Data

Material	PA12 GF50
Operating Pressure, Max.	12.5 bar

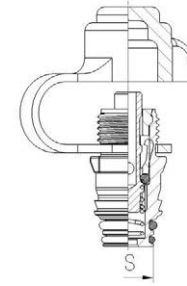

Title	S	Weight	PU Piece	Article No.
ABC Treadless Test Point ISO 3583	Regular	12 g	5	136953

AGR: 16.941

T- Plug-in Connector

Technical Data

Operating Temperature, Up To	75 °C
Operating Pressure, Max.	15 bar
Material	Polyacetal POM

Title	Connection 1, Internal-Ø	PU Piece	Article No.
T- Plug-in Connector	4 mm	10	111876
T- Plug-in Connector	6 mm	10	118331
T- Plug-in Connector	8 mm	10	118332
T- Plug-in Connector	10 mm	10	118333
T-Plug-in Connector	12 mm	10	119763

AGR: 16.941

Straight Plug-in Connector

Technical Data

Operating Temperature, Up To	75 °C
Operating Pressure, Max.	15 bar
Material	Polyacetal POM

Title	Connection 1, Internal-Ø	PU Piece	Article No.
Plug-in Connector	15 mm	10	140534
Plug-in Connector	4 mm	10	111871
Plug-in Connector	6 mm	10	118328
Plug-in Connector	8 mm	10	118329
Plug-in Connector	10 mm	10	118330
Plug-in Connector	12 mm	10	119764

AGR: 16.941

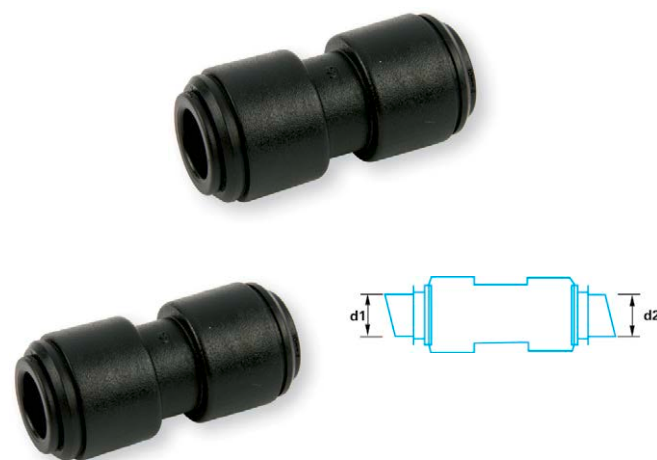
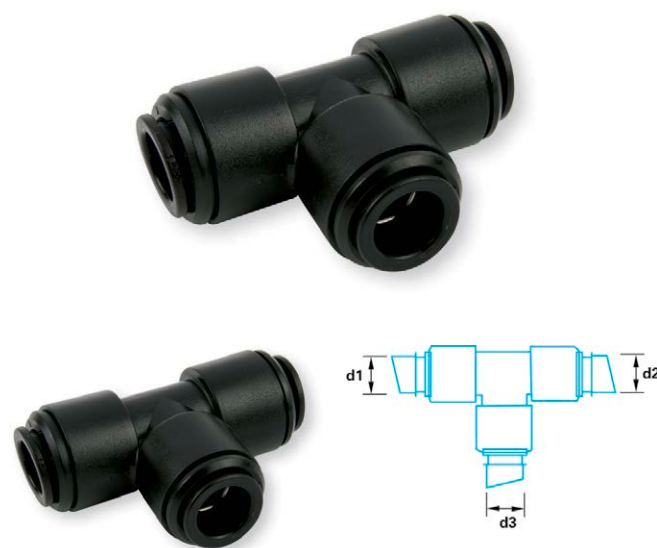

Elbow Screw-in Connector

Application Area

- Production of detachable, air pressure-tight cable connections and branches
- Only for secondary consumers

Processing Information

- Installation by simply inserting the tube
- Disassembly by pushing the clamping element and simultaneous retraction of the tube

Technical Data

Operating Temperature, Up To	75 °C
Operating Pressure, Max.	15 bar
Material	Polyacetal POM

Title	Connection 1, Internal-Ø	PU Piece	Article No.
Elbow Screw-in Connector	4 mm	10	111874*
Elbow Screw-in Connector	6 mm	10	118334
Elbow Screw-in Connector	8 mm	10	118335
Elbow Screw-in Connector	10 mm	10	118336*
Elbow Screw-in Connector	12 mm	10	119762*

* = The delivery time is 21 days

AGR: 16.941

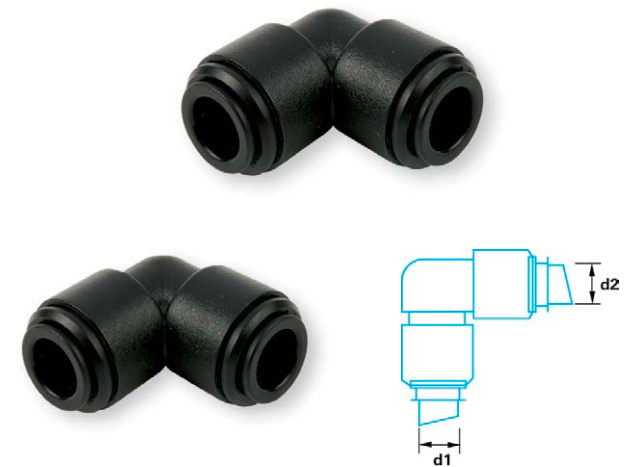

Straight Screw-in Connector

Technical Data

Material

Plastic

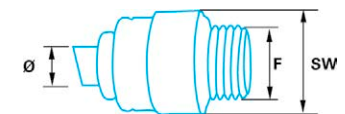
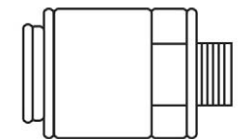

Title	Connection 1, Internal-Ø	Connection 2, External Thread, Inch	Wrench Width	PU Piece	Article No.
STRAIGHT SCREW C. POM,Ø04-1/8"	4 mm	1/8 "	14 mm	5	029495*
STRAIGHT SCREW C. POM,Ø06-1/8"	6 mm	1/8 "	15 mm	5	029497
STRAIGHT SCREW C. POM,Ø06-1/4"	6 mm	1/4 "	17 mm	5	029498
STRAIGHT SCREW C. POM,Ø08-1/4"	8 mm	1/4 "	17 mm	5	029500
STRAIGHT SCREW C. POM,Ø08-1/8"	8 mm	1/8 "	17 mm	5	029499*
STRAIGHT SCREW C. POM,Ø10-1/4"	10 mm	1/4 "	20 mm	5	029501*

* = The delivery time is 21 days

AGR: 16.941

Elbow Screw-in Connector (Rotatable)

Technical Data

Material Plastic



11



Title	Connection 1, Internal-Ø	Connection 2, External Thread, Inch	Wrench Width	PU Piece	Article No.
ELBOW SCREW CON. POM, Ø04-1/8"	4 mm	1/8 "	14 mm	5	029505*
Elbow Screw-in Connector (Rotatable)	6 mm	1/8 "	15 mm	5	029507
Elbow Screw-in Connector (Rotatable)	6 mm	1/4 "	17 mm	5	029508
Elbow Screw-in Connector (Rotatable)	8 mm	1/4 "	17 mm	5	029510
Elbow Screw-in Connector (Rotatable)	8 mm	1/8 "	17 mm	5	029509
ELBOW SCREW CON. POM, Ø10-1/4"	10 mm	1/4 "	20 mm	5	029511*

* = The delivery time is 21 days

AGR: 16.941

Reduction connector

Technical Data

Material

Plastic



Title	Connection 1, Internal-Ø	Connection 2, Internal-Ø	PU Piece	Article No.
REDUCE CONNECTOR POM, Ø06/Ø04	4 mm	6 mm	5	031032
REDUCE CONNECTOR POM, Ø08/Ø04	4 mm	8 mm	5	031033*
REDUCE CONNECTOR POM, Ø08/Ø06	6 mm	8 mm	5	687839
REDUCE CONNECTOR POM, Ø10/Ø06	6 mm	10 mm	5	687847*
REDUCE CONNECTOR POM, Ø10/Ø08	8 mm	10 mm	5	687855*

* = The delivery time is 21 days

AGR: 16.941

Y- Plug-in Connector

Technical Data

Material		Plastic	
Title	Connection 1, Internal-Ø	PU Piece	Article No.
Y-PLUG CONNECTOR POM, Ø04	4 mm	5	024120*
Y- Plug-in Connector	6 mm	5	024140*
Y- Plug-in Connector	8 mm	5	024141*
Y-PLUG CONNECTOR POM, Ø10	10 mm	5	024142*
Y-PLUG CONNECTOR POM, Ø12	12 mm	5	024143*

* = The delivery time is 21 days
 AGR: 16.941

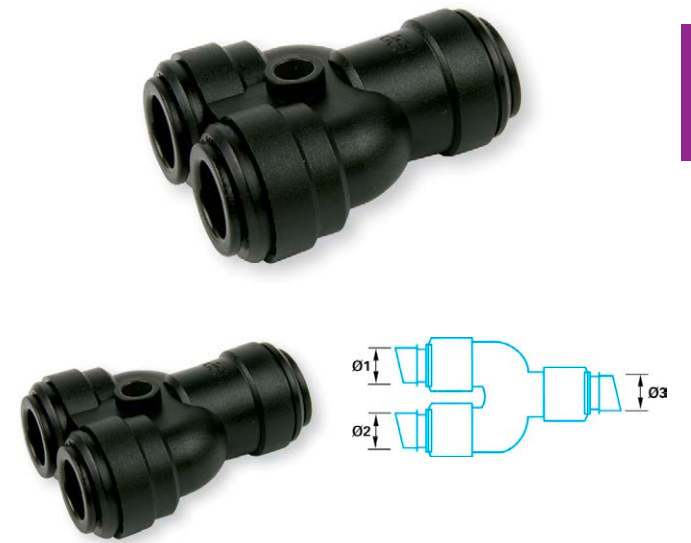

11

ABC Threadless Push-In Coupling

Technical Data

Material	PA12 GF50
----------	-----------

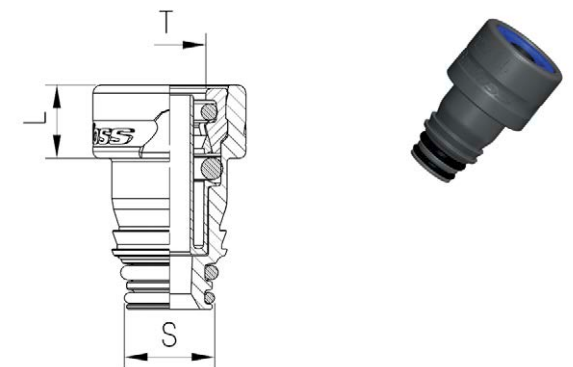

Title	S	T	L	Weight	PU Piece	Article No.
Threadless Push-In Coupling	Regular	6x1	4 mm	6 g	5	136883
Threadless Push-In Coupling	Regular	8x1	8 mm	7 g	5	136884
Threadless Push-In Coupling	Regular	10x1	11 mm	9 g	5	136890
Threadless Push-In Coupling	Regular	10x1,25	11 mm	9 g	5	136891
Threadless Push-In Coupling	Regular	12x1,5	18 mm	11 g	5	136897
Threadless Push-In Coupling	Heavy Duty	12x1,5	18 mm	12 g	5	136905
Threadless Push-In Coupling	Heavy Duty	15x1,5	21 mm	22 g	5	136913
Threadless Push-In Coupling	Heavy Duty	16x2	21 mm	22 g	5	136921

AGR: 16.941

INTERNAL/Approved (2019-03-22 22:23:42)

ABC Integral Push-In 90°

Technical Data

Material	PA12 GF50
Operating Pressure, Max.	12.5 bar

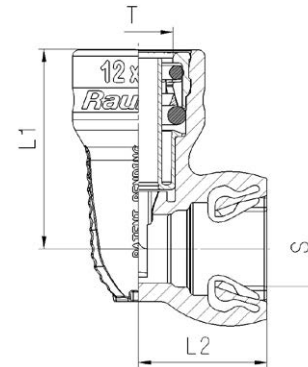

Title	S	T	L1	L2	Weight	PU Piece	Article No.
Integral Push-In 90°	Regular	6x1	31 mm	21 mm	13 g	5	136930
Integral Push-In 90°	Regular	10x1	35 mm	24 mm	18 g	5	136939
Integral Push-In 90°	Regular	10x1,25	35 mm	24 mm	18 g	5	136941
Integral Push-In 90°	Regular	12x1,5	37 mm	24 mm	20 g	5	136942
Integral Push-In 90°	Heavy Duty	15x1,5	46 mm	31 mm	36 g	5	136944
Integral Push-In 90°	Heavy Duty	16x2	46 mm	31 mm	35 g	5	136945

AGR: 16.941

ABC Union 45° Elbow

Technical Data

Material	PA12 GF50
Operating Pressure, Max.	12.5 bar

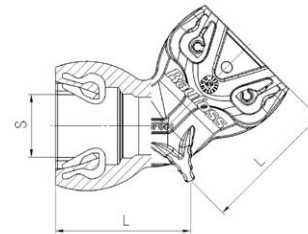

Title	S	L	Weight	PU Piece	Article No.
Elbow 45°	Regular	25 mm	14 g	5	136946

AGR: 16.941

ABC Union 90° Elbow

Technical Data

Material	PA12 GF50
Operating Pressure, Max.	12.5 bar

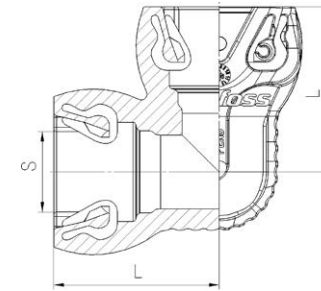

11

Title	S	L	Weight	PU Piece	Article No.
Elbow 90°	Regular	34 mm	25 g	5	136947
Elbow 90°	Heavy Duty	29 mm	15 g	5	136948

AGR: 16.941

ABC Union F

Technical Data

Material	PA12 GF50
Operating Pressure, Max.	12.5 bar

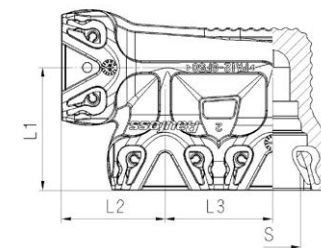

Title	S	L1	L2	L3	Weight	PU Piece	Article No.
Union F	Regular	31 mm	26.1 mm	27 mm	25 g	5	136949

AGR: 16.941

ABC Union Y

Technical Data

Material	PA12 GF50
Operating Pressure, Max.	12.5 bar

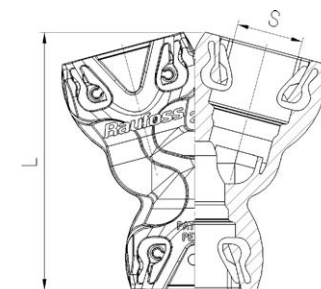

Title	S	L	Weight	PU Piece	Article No.
Union Y	Regular	54.8 mm	21 g	5	136952

AGR: 16.941

INTERNAL/Approved (2019-03-22 22:24:00)

ABC Reducer

Technical Data

Material	PA12 GF50
Operating Pressure, Max.	12.5 bar

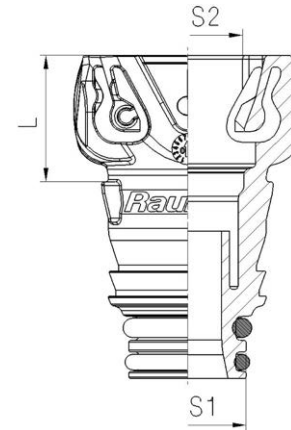

Title	S1	S2	L1	Weight	PU Piece	Article No.
Reducer	Heavy Duty	Regular	15.1 mm	11 g	5	136954

AGR: 16.941

ABC Union Female

Technical Data

Material	PA12 GF50
Operating Pressure, Max.	12.5 bar

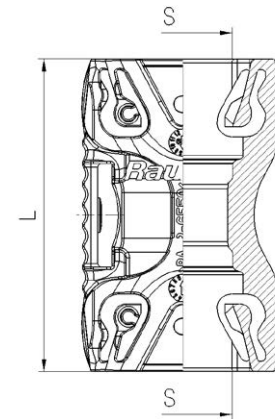

Title	S	L	Weight	PU Piece	Article No.
Union Female	Regular	45 mm	13 g	5	136955

AGR: 16.941

ABC Release Tool Standard

Application Area

- Easy dismantling of polyamide pipes out of the ABC quick plug coupling

Technical Data

Material Plastic

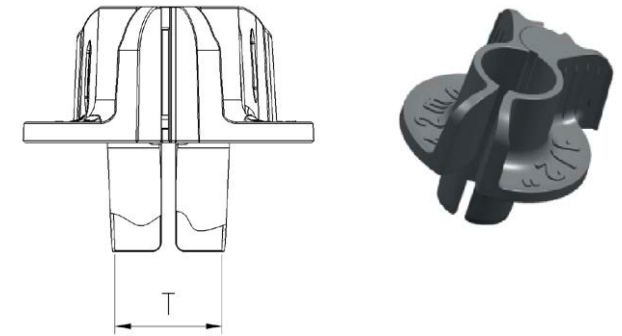

11

Title	T	Weight	PU Piece	Article No.
Release Tool	6x1	4 g	5	136961
Release Tool	8x1	2 g	5	136962
Release Tool	10x1; 10x1,25; 10x1,5	2 g	5	136963
Release Tool	12x1,5	5 g	5	136964
Release Tool	15x1,5	7 g	5	136965
Release Tool	16x2	6 g	5	136966

AGR: 16.941

ABC Push-In Plug

Application Area

- Sealing for ABC fitting, protection against dirt

Technical Data

Material Plastic

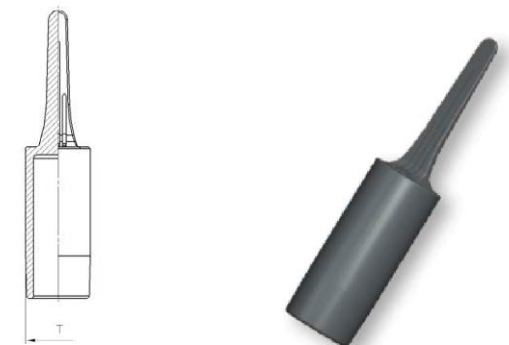

Title	T	Weight	PU Piece	Article No.
Push-In Plug	8x1	1 g	5	136967
Push-In Plug	12x1,5	2 g	5	136968

AGR: 16.941

Straight Plug Connector

Technical Data

Material Steel zinc plated

Title	Connection 1, Internal-Ø	PU Piece	Article No.
Plug-in Connector	6 mm	5	799289
Plug-in Connector	8 mm	5	032652
Plug-in Connector	9 mm	5	014953
Plug-in Connector	10 mm	5	032653
Plug-in Connector	11 mm	5	014954
Plug-in Connector	12 mm	5	799106
Plug-in Connector	14 mm	5	024159
Plug-in Connector	15 mm	5	024160
Plug-in Connector	16 mm	5	033172
CA STRAIGHT-PLUG CONNECTOR Ø04	4 mm	5	024157

AGR: 16.941

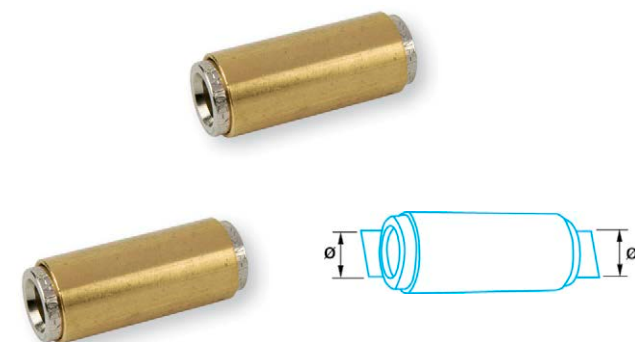

T-Plug-in Connector

Technical Data

Material Steel zinc plated

Title	Connection 1, Internal-Ø	PU Piece	Article No.
CA T-PLUG CONNECTOR Ø04	4 mm	5	024145*
T-Plug-in Connector	6 mm	5	033167
T-Plug-in Connector	8 mm	5	799025
T-Plug-in Connector	9 mm	5	024146
T-Plug-in Connector	10 mm	5	032647
T-Plug-in Connector	11 mm	5	024147
T-Plug-in Connector	12 mm	5	032648
T-Plug-in Connector	15 mm	5	024150

* = The delivery time is 21 days

AGR: 16.941

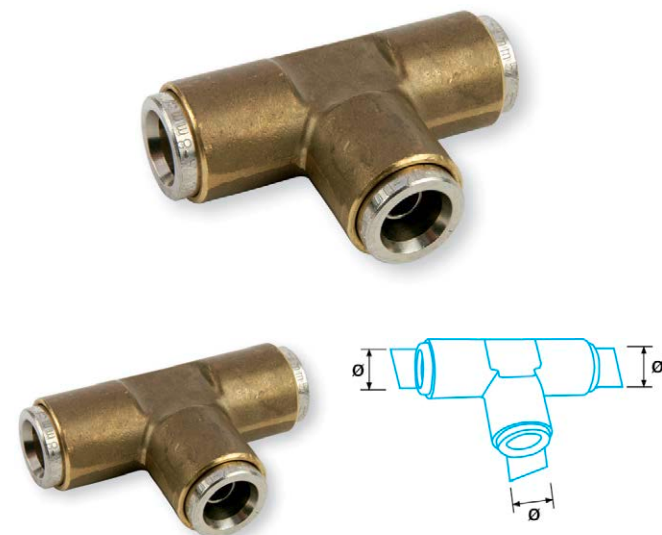

INTERNAL/Approved (2019-03-22 22:24:23)

Elbow Plug-in Connector

Technical Data

Material Steel zinc plated

Title	Connection 1, Internal-Ø	PU Piece	Article No.
Elbow Plug-in Connector	6 mm	5	033157
Elbow Plug-in Connector	8 mm	5	032649
Elbow Plug-in Connector	9 mm	5	024153
Elbow Plug-in Connector	10 mm	5	032650
Elbow Plug-in Connector	12 mm	5	032651

AGR: 16.941



Straight Screw-in Connector

Technical Data

Material

Brass

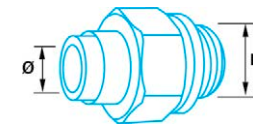

Title	Connection 1, Internal-Ø	Thread A2 external	Wrench Width	PU Piece	Article No.
Straight Screw-in Connector	6 mm	M 10 x 1.5 mm	14 mm	5	033160
Straight Screw-in Connector	6 mm	M 12 x 1.5 mm	17 mm	5	033161
Straight Screw-in Connector	8 mm	M 12 x 1.5 mm	17 mm	5	032655
Straight Screw-in Connector	8 mm	M 16 x 1.5 mm	22 mm	5	032656
Straight Screw-in Connector	10 mm	M 16 x 1.5 mm	22 mm	5	032657
Straight Screw-in Connector	12 mm	M 16 x 1.5 mm	22 mm	5	032659

AGR: 16.941

Elbow Screw-in Connector

Technical Data

Material Brass

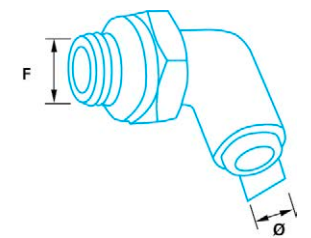

Title	Connection 1, Internal-Ø	Thread A2 external	Wrench Width	PU Piece	Article No.
Elbow Screw-in Connector	8 mm	M 16 x 1.5 mm	24 mm	5	799300*
Elbow Screw-in Connector	8 mm	M 22 x 1.5 mm	30 mm	5	033325
Elbow Screw-in Connector	10 mm	M 16 x 1.5 mm	24 mm	5	167526
Elbow Screw-in Connector	12 mm	M 16 x 1.5 mm	24 mm	5	033326
Elbow Screw-in Connector	12 mm	M 22 x 1.5 mm	30 mm	5	033327
CA ELB. SCREW CON. Ø16/M22X1,5	16 mm	M 22 x 1.5 mm	30 mm	5	033329*

* = The delivery time is 21 days

AGR: 16.941

INTERNAL/Approved (2019-03-22 22:24:57)

ABC Swivel

Technical Data

Material	Brass
Operating Pressure, Max.	12.5 bar

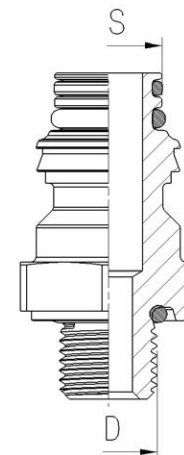

Title	S	D	Weight	PU Piece	Article No.
Swivel	Regular	M12x1,5	29 g	5	136873
Swivel	Regular	M14x1,5	34 g	5	136874
Swivel	Regular	M16x1,5	39 g	5	136876
Swivel	Regular	M22x1,5	51 g	5	136877
Swivel	Heavy Duty	M16x1,5	45 g	5	136878
Swivel	Heavy Duty	M22x1,5	60 g	5	136879

AGR: 16.941

ABC Swivel Bulkhead long with cone

Technical Data

Material	Brass
Operating Pressure, Max.	12.5 bar

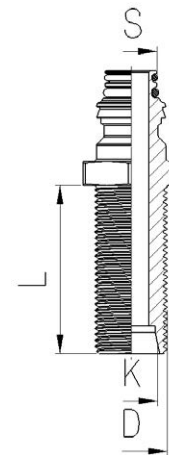

11

Title	S	D	L	K	Weight	PU Piece	Article No.
Swivel Bulkhead long w. cone	Regular	M18x1,5	42 mm	24°-12	98 g	5	136881

AGR: 16.941

Related Products

Related Products	PU Piece	Article No.
Counter-Nuts M 18x 1,5 x1,5	25	112087

ABC Swivel Bulkhead

Technical Data

Material	Brass
Operating Pressure, Max.	12.5 bar

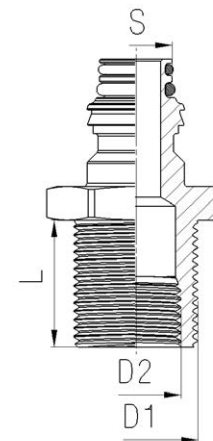

Title	S	D1	D2	L	Weight	PU Piece	Article No.
Swivel Bulkhead	Regular	M22x1,5	M16x1,5	23 mm	84 g	5	136880

AGR: 16.941

Related Products

Related Products	PU Piece	Article No.
Counter-Nuts M 22x 1,5 x1,5	25	112088

INTERNAL/Approved (2019-03-22 22:25:13)

PA Pipes for Brake Systems

- UV-resistant due to soot content of polyamide

Application Area

- Airbrake systems and auxiliary consumers, fuel promotion

Characteristics

- PA 12, fuel and diesel-resistant material and construction according to DIN 74324, requirements and testing in accordance with DIN 73378

Processing Information

- Cutting pipes to check with a pipe cutter (see accessories)

Hints

- BKS cable clamps can be used for fixing the pipe:
High-strength cable gland type 16 for cable diameter of 22 mm:
Art- No. 135570
High-strength cable gland type 9 for cable diameter of 15 mm:
Art-No. 135567
- Or articulated pipe clamps G-ROHS:
Art.-No. 136440 clamping range 15 – 18 mm
Art.-No. 316253 clamping range 20 – 23 mm



Technical Data

Material	PA 12
Norms	DIN 74324

Title	Size	External-Ø	Diameter Internal	Wall Thickness	Length	Bending Radius	Operating Pressure	Burst Pressure	PU Ring	Article No.
PU Tube	4 x 1	4 mm	2 mm	1 mm	25 m	20 mm	45 bar	135 bar	1	028678
PU Tube	6 x 1	6 mm	4 mm	1 mm	25 m	30 mm	26 bar	78 bar	1	111790
PU Tube	8 x 1	8 mm	6 mm	1 mm	25 m	50 mm	19 bar	57 bar	1	111792
PU Tube	9 x 1.5	9 mm	6 mm	1.5 mm	25 m	40 mm	26 bar	78 bar	1	111793
PU Tube	10 x 1	10 mm	8 mm	1 mm	25 m	40 mm	14 bar	42 bar	1	111794
PU Tube	11 x 1.5	11 mm	8 mm	1.5 mm	25 m	55 mm	21 bar	63 bar	1	111795
PU Tube	12 x 1.5	12 mm	9 mm	1.5 mm	25 m	70 mm	19 bar	57 bar	1	111796
PU Tube	15 x 1.5	15 mm	12 mm	1.5 mm	25 m	90 mm	14 bar	42 bar	1	111797
PU Tube	16 x 2	16 mm	12 mm	2 mm	25 m	95 mm	19 bar	57 bar	1	142374

INTERNAL/Approved (2019-03-22 22:25:17)

PU Tube	18 x 2	18 mm	14 mm	2 mm	25 m	100 mm	16 bar	48 bar	1	024167
---------	--------	-------	-------	------	------	--------	--------	--------	---	--------

AGR: 16.942

Accessories Available

	PU Piece	Article No.
Pipe Cutter for PA Pipes up to Ø 28mm	1	113063
Pipe cutter up to 15 Ø mm	1	170550

Cutting Pliers for PA-Pipe

Application Area

- Cutting of PA pipes of up to Ø 28 mm

Technical Data

Grip Material	1 component handle
---------------	--------------------

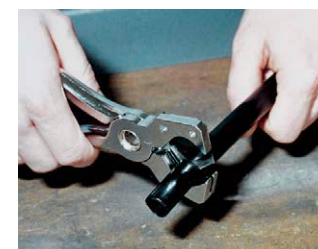

Title	Length	Cutting Performance-Ø Wire	PU Piece	Article No.
Pipe Cutting Pliers for PA Pipe	255 mm	28 mm	1	113063

AGR: 03.209

Spare Parts

	PU Piece	Article No.
SPARE BLADE FOR 113063	1	051191

Hose Cutter for Pipe

Title	Length total (mm)	PU Piece	Article No.
Pipe cutter up to 15 Ø mm AGR: 03.500	80 mm	1	170550



Brake Hoses DIN 74310

Characteristics

- Made of synthetic rubber with flame-proof, textile inserts, corresponds to DIN 74310

Technical Data

Material	Synthetic rubber with pressure resistant textile inlays
Norms	DIN 74310



11



Title	Size	External-Ø	Diameter Internal	Wall Thickness	Length	Operating Pressure	Burst Pressure	PU Ring	Article No.
Brake Hose	18 x 3.5	18 mm	11 mm	3.5 mm	20 m	10 bar	50 bar	1	026922
Brake Hose	25 x 6	25 mm	13 mm	6 mm	20 m	10 bar	50 bar	1	026924

AGR: 16.943

Accessories Available

	PU Piece	Article No.
Fuel Hose Clamps MINI Aba MINI S wide 15 mm, Ø 25 mm	50	015466

INTERNAL/Approved (2019-03-22 22:25:38)

PA Pneumatic Coiled Hose

- Adapter system for universal use, and low storage space
- Possible and easy connection, since spiral does not rotate on assembly

Application Area

- Safe compressed air connection to the trailer towing vehicle / Trailers

Characteristics

- PA 12 polyamide 12 x 1.5, operating pressure up to max. 10 bar, operating temperature of -40 ° C to +70 ° C corresponds to DIN 74 323, with protection bend made of plastic, oil, grease and acid-resistant, double M 18 x 1,5 IG, connections are made of galvanized steel

Processing Information

- Only use in conjunction with suitable adapters

Hints

- Tube colour: black
Order Adapter for coiled cable separately

Scope Of Delivery

- Adapter for coiled hoses should be ordered separately

Technical Data

Material	Polyamide (PA)
Norms	DIN 74323
Operating Temperature, Of	-40 °C
Operating Temperature, Up To	70 °C
Resistant Against	Oil Fat Acids



Title	Working Length	Length total (mm)	Spiral External Ø	Spiral Internal Ø	Connecting thread	Color	Number of windings	PU Piece	Article No.
PA Pneumatic Coiled Hose	4 m	6.3 m	110 mm	86 mm	M18 x 1.5 mm	Red	20 PC	1	024168
PA Pneumatic Coiled Hose	4 m	6.3 m	110 mm	86 mm	M18 x 1.5 mm	Yellow	20 PC	1	024169

AGR: 16.944

INTERNAL/Approved (2019-03-22 22:25:40)

PU Pneumatic Coiled Hose

- Robust polyurethane for high service life
- High flexibility and good recovery even at low temperatures

Application Area

- Safe compressed air connection to the trailer towing vehicle / Trailers

Characteristics

- PUR polyurethane 12 x 2.0, operating pressure up to max. 10 bar, operating temperature of -40 ° C to +70 ° C, based on DIN 74 323 and DIN 74324, with kink protection spring, oil, grease, fuel, ozone and UV-resistant, double-sided M 16 x 1.5 AG

Technical Data

Material	Polyurethane (PU)
Norms	DIN 74323
Operating Temperature, Of	-40 °C
Operating Temperature, Up To	70 °C
Resistant Against	Oil Fat Petrol Ozone UV resistance



Title	Working Length	Length total (mm)	Spiral External Ø	Spiral Internal Ø	Connecting thread	Color	Number of windings	PU Piece	Article No.
Pneumatic Coiled Hose PU	4 m	4.8 m	80 mm	56 mm	M16 x 1.5 mm	Red	24 PC	1	024173
Pneumatic Coiled Hose PU	4 m	4.8 m	80 mm	56 mm	M16 x 1.5 mm	black	24 PC	1	024176

AGR: 16.944

Air Spiral hose ECOPUR

Hints

- The ECOPU - helical cables are a cost saving alternative to the supply pipeline Art.-No. 024173 and Art.-No. 024174. Technical ident.

Technical Data

Material	Polyurethane (PU)
Norms	DIN 74323



Title	Working Length	Spiral Internal Ø	Color	Number of windings	PU Piece	Article No.
BRAKE COILS ECOPUR 4MT D.8 RED	4 m	46 mm	Red	24 PC	1	129612
BRAKE COIL ECOPUR 4MT D8YELLOW	4 m	46 mm	Yellow	24 PC	1	129613

AGR: 16.944

Additional Handles For Coiled Hoses

- Simple and safe coupling and solving spiral coiled hoses

Characteristics

- Ergonomically designed handle with eyelet

Scope Of Delivery

- Set includes one red and one yellow handle

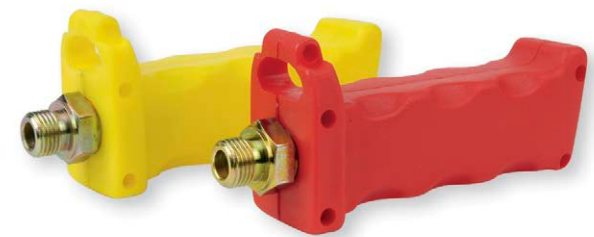

Title	PU Piece	Article No.
Additional Handle	1	014776

AGR: 16.944

Short Adapter M 16

Application Area

- Mercedes Benz, DAF, Renault, Scania, Iveco, Volvo

Characteristics

- Galvanized steel

Processing Information

- For each coiled hose 2 adapters are needed

Technical Data

Material	Steel zinc plated
Norms	Road vehicles, compressed air brake installation, identification of equipment connections

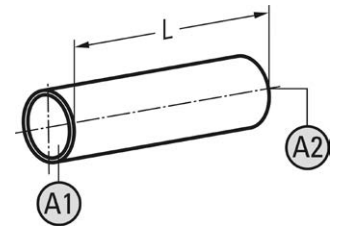
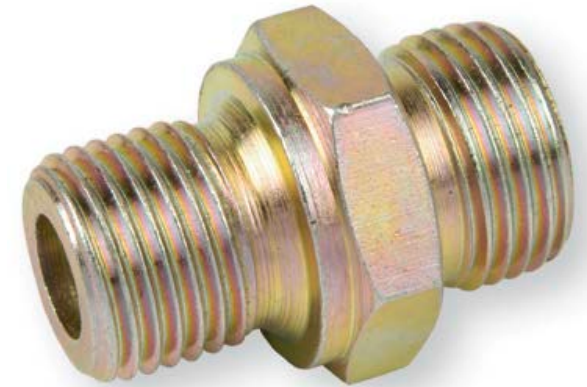

Title	External thread x thread pitch	External thread x thread pitch	PU Piece	Article No.
Short Adapter	M 16 x 1.5 mm	M 18 x 1.5 mm	1/10	163339

AGR: 16.944

Long Adapter M 16

Application Area

- MAN and Renault

Characteristics

- Galvanized steel, length 34 mm

Processing Information

- For each coiled hose 2 adapters are needed

Technical Data

Material	Steel zinc plated
Norms	Road vehicles, compressed air brake installation, identification of equipment connections

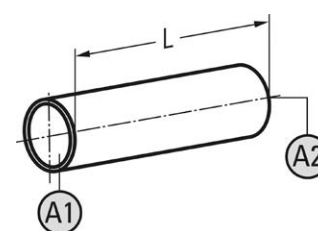
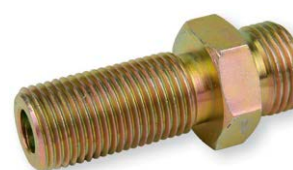
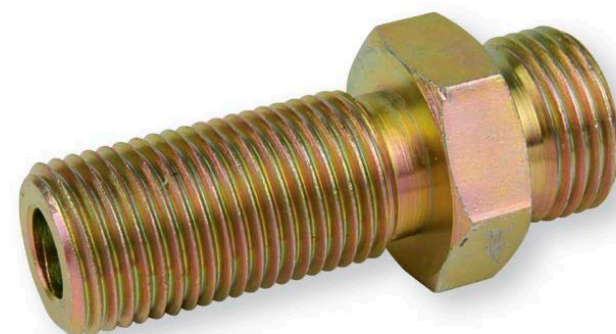

Title	External thread x thread pitch	External thread x thread pitch	PU Piece	Article No.
Long Adapter	M 16 x 1.5 mm	M 18 x 1.5 mm	1/10	163340

AGR: 16.944

Adapter M 18

Application Area

- MAN, Scania and Iveco

Characteristics

- Galvanized steel, length 34 mm

Processing Information

- For each coiled hose 2 adapters are needed

Technical Data

Material	Steel zinc plated
Norms	Road vehicles, compressed air brake installation, identification of equipment connections

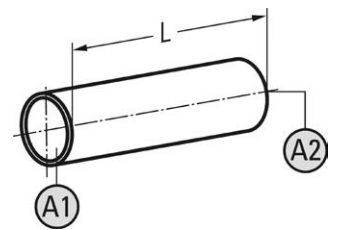

Title	External thread x thread pitch	External thread x thread pitch	PU Piece	Article No.
Adapter	M 18 x 1.5 mm	M 18 x 1.5 mm	1/10	163338

AGR: 16.944

Adapter M 22

Application Area

- Universal use

Characteristics

- Galvanized steel

Processing Information

- For each coiled hose 2 adapters are needed

Technical Data

Material Steel zinc plated

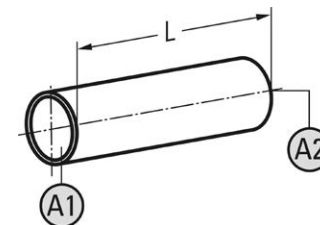
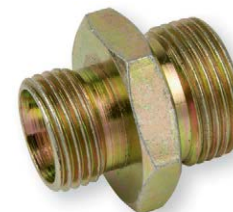

Title	External thread x thread pitch	External thread x thread pitch	PU Piece	Article No.
Adapter M 22	M 18 x 1.5 mm	M 22 x 1.5 mm	1/10	163337

AGR: 16.944

Automatic Coupling Heads

Application Area

- Quick coupling for coiled cable between the tractor and trailers or semi-trailer
- Sided Tractor

Characteristics

- Provided with check valve, according to DIN 74 254



11

Technical Data

Norms	DIN 74254
Place Of Use	on the tractor vehicle

Title	Color	Thread	According Number Mabco	PU Piece	Article No.
Supply	Red	M 16 x 1.5	9522002210	1	111889
Supply	Red	M 22 x 1.5	4522002110	1	111890
Brake	Yellow	M 16 x 1.5	9522002220	1	111891
Brake	Yellow	M 22 x 1.5	4522002120	1	111892

AGR: 16.945

Standard Coupling Heads

11

Application Area

- Quick coupling for coiled cable between the tractor and trailers or semi-trailer
- Sided trailers / Semi-trailers

Characteristics

- Complies with DIN 74 524

Technical Data

Norms	DIN 74254
Place Of Use	on the trailer



Title	Color	Thread	According Number Mabco	PU Piece	Article No.
Supply	Red	M 16 x 1.5	9522000210	1	111896
Supply	Red	M 22 x 1.5	4522000110	1	111895
Brake	Yellow	M 16 x 1.5	9522000220	1	111894
Brake	Yellow	M 22 x 1.5	4522000120	1	111893

AGR: 16.945

Spare Parts	PU Piece	Article No.
Rubber seal for Standard Coupling Heads	25	111897

Rubber gasket for standard coupling head



11

Title	PU Piece	Article No.
Rubber seal for Standard Coupling Heads AGR: 16.945	25	111897

Brake Rings with O-Ring

Title	for threads	PU Piece	Article No.
Brake Rings with O-Ring	M 12	50	111878
Brake Rings with O-Ring	M 14	50	111879
Brake Rings with O-Ring	M 16	50	111881
Brake Rings with O-Ring	M 18	50	111882
Brake Rings with O-Ring	M 22	50	111883

AGR: 16.946

Spare O-rings for brake rings

Technical Data

Material Perbunan

Title	for threads	PU Piece	Article No.
For replacement O-rings for brake rings	M 12	50	111884
For replacement O-rings for brake rings	M 14	50	111885
For replacement O-rings for brake rings	M 16	50	111886
For replacement O-rings for brake rings	M 18	50	111887
For replacement O-rings for brake rings	M 22	50	111888

AGR: 16.946



Copper Brake Pipes

Application Area

- Brake pipes with CuNiFe-alloy according to DIN 74234 may only be installed if:
 - the motor vehicle does not have an ESP or a brake assistant, because the peak pressure can rise up to over 200 Hpa and
 - if there is a manufacturer authorization for the usage of DIN brake pipes (so far only known for several Peugeot and Renault models).

Characteristics

- Material: CuNi10Fe1Mn
90% copper and 10% nickel, Ø 4.75 x 0.78 mm, meets the requirements of BS 2871, EN 12449, DIN 74234, CN 102, SAE J527, ASTM A254, SMMT C5B

Processing Information

- Only use the appropriate tools to process



Title	External-Ø	Lengths, Meter	PU Roll	Article No.
BRAKE PIPE COPPER 4.75 7,62M	4.75 mm	7.62 m	1	058044

AGR: 16.311

Brake Pipe CU/NI

- % 90 bakır ve% 10 nikel

Characteristics

- 90% copper and 10% nickel

Processing Information

- Only use the appropriate tools to process
- The recommendations of the vehicle manufacturer have to be observed if these brake pipes are used and if the brake pipes get exchanged

Hints

- meets the requirements according to DIN 74234, BS 2871, EN 12449, CN 102, SAE J527, ASTM A254, SMMT C5B
- Article number 053586 and 176084 are examined electronically through eddy current testing



Ø 4,75 mm

Title	External-Ø	Lengths, Meter	PU Roll	Article No.
BRAKE PIPE CU/NP 4.75 5METER	4.75 mm	5 m	1	176084
BRAKE PIPE CU/NP 4.75 10METER	4.75 mm	10 m	1	053586
BRAKE PIPE CU/NP 7,75 25 METER	4.75 mm	25 m	1	031093

AGR: 16.311

Plastic Coated Brake Pipe

Characteristics

- additionally made of zinc-copper-plated steel strip inside and outside
- plastic coated

Processing Information

- Only use the appropriate tools to process

Scope Of Delivery

- 2 x 5 m

Title	External-Ø	Lengths, Meter	PU Amount	Article No.
Plastic Coated Brake Pipe	4.75 mm	10 m	1	402290
Plastic Coated Brake Pipe	6 mm	10 m	1	402303

AGR: 16.311

Brake Pipe Nipple BRT 001

Application Area

- DIN-Flare F and double flaring

Technical Data

Flange Shape	DIN hem F, double hemming
Material	Steel
Surface protection	zinc plated

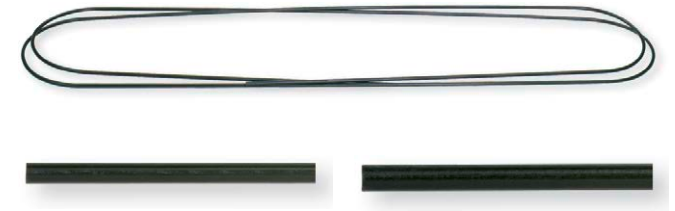

11



Brake line nipples and pipes

11

Title	Reference Vehicle Manufacturer	For Pipeline-Ø	Thread	Length	Wrench Width	PU Piece	Article No.
Brake Pipe Nipple BRT 001	Alfa Romeo	4.75 mm	M 10 x 1	16.7 mm	11 mm	25	222313
	Audi						
	BMW						
	Citroen						
	Dacia						
	Fiat						
	Ford						
	Honda						
	Mercedes Benz						
	Mitsubishi						
	Nissan						
	Opel / Vauxhall						
	Peugot						
	Renault						
	Rover						
	Saab						
	Seat						
	Skoda						
Talbot							
Volvo							
VW							

AGR: 16.400

Brake Pipe Nipple BRT 002

Application Area

- DIN Flare F and double flaring

Technical Data

Flange Shape	DIN hem F, double hemming
Material	Steel
Surface protection	zinc plated



11

Title	Reference Vehicle Manufacturer	For Pipeline-Ø	Thread	Length	Wrench Width	PU Piece	Article No.
Brake Pipe Nipple BRT 002	Audi BMW Fiat Ford Mercedes Benz Saab Volvo VW	4.75 mm	M 10 x 1	24.8 mm	11 mm	25	222399

AGR: 16.400

Brake Pipe Nipple BRT 003

Application Area

- DIN Flare F and double flaring

Technical Data

Flange Shape	DIN hem F, double hemming
Material	Steel
Surface protection	zinc plated



INTERNAL/Approved (2019-03-22 22:27:03)

Title	Reference Vehicle Manufacturer	For Pipeline-Ø	Thread	Length	Wrench Width	PU Piece	Article No.
Brake Pipe Nipple BRT 003	Daihatsu Hyundai Nissan Opel / Vauxhall Skoda Toyota VW	4.75 mm	M 10 x 1	16.7 mm	10 mm	25	222402

AGR: 16.400

Brake line nipples and pipes

Brake Pipe Nipple BRT 004

Application Area

- DIN Flare F and double flaring

Technical Data

Flange Shape	DIN hem F, double hemming
Material	Steel
Surface protection	zinc plated



Title	Reference Vehicle Manufacturer	For Pipeline-Ø	Thread	Length	Wrench Width	PU Piece	Article No.
Brake Pipe Nipple BRT 004	Alfa Romeo	4.75 mm	M 12 x 1	20 mm	12 mm	25	222410
	Audi						
	Citroen						
	Fiat						
	Honda						
	Opel / Vauxhall						
	Peugot						
	Renault						
	Rover						
	Saab						
	Seat						
	Skoda						
	Volvo						
VW							

AGR: 16.400

Brake Pipe Nipple BRT 005

Application Area

- DIN Flare F and double flaring

Technical Data

Flange Shape	DIN hem E, simple hemming
Material	Steel
Surface protection	zinc plated



Title	Reference Vehicle Manufacturer	For Pipeline-Ø	Thread	Length	Wrench Width	PU Piece	Article No.
Brake Pipe Nipple BRT 005	Bedford Ford Rover Saab Senbeam Talbot	4.75 mm	UNF 3/8 x 24	17.5 mm	14 mm	25	222429

AGR: 16.401

Brake line nipples and pipes

Brake Pipe Nipple BRT 006

Application Area

- DIN Flare F and double flaring

Technical Data

Flange Shape	DIN hem E, simple hemming
Material	Steel
Surface protection	zinc plated



Title	Reference Vehicle Manufacturer	For Pipeline-Ø	Thread	Length	Wrench Width	PU Piece	Article No.
Brake Pipe Nipple BRT 006	Alfa Romeo	4.75 mm	M 10 x 1	13 mm	14 mm	25	222437
	Audi						
	Citroen						
	Fiat						
	Ford						
	Opel / Vauxhall						
	Peugot						
	Renault						
	Rover						
	Saab						
	Seat						
VW							

AGR: 16.400

Brake Pipe Nipple BRT 007

Application Area

- DIN Flare F and double flaring

Technical Data

Flange Shape	DIN hem F, double hemming
Material	Steel
Surface protection	zinc plated



11

Title	Reference Vehicle Manufacturer	For Pipeline-Ø	Thread	Length	Wrench Width	PU Piece	Article No.
Brake Pipe Nipple BRT 007	Bedford Ford Peugot Renault Rover Saab Senbeam Talbot Volvo	4.75 mm	UNF 3/8 x 24	21 mm	11 mm	25	222445

AGR: 16.401

Brake Pipe Nipple BRT 008

Application Area

- DIN Flare F and double flaring

Technical Data

Flange Shape	DIN hem F, double hemming
Material	Steel
Surface protection	zinc plated

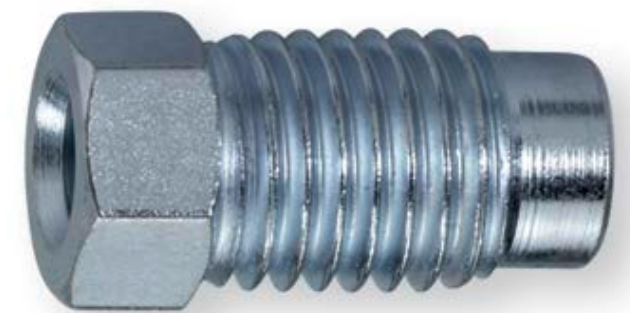

INTERNAL/Approved (2019-03-22 22:27:22)

Title	Reference Vehicle Manufacturer	For Pipeline-Ø	Thread	Length	Wrench Width	PU Piece	Article No.
Brake Pipe Nipple BRT 008	Autobianchi Dacia Fiat Lada Lancia Zastava	4.75 mm	M 10 x 1.25	19.5 mm	10 mm	25	222453

AGR: 16.400

Brake line nipples and pipes

Brake Pipe Nipple BRT 009

Application Area

- DIN Flare F and double flaring

Technical Data

Flange Shape	DIN hem F, double hemming
Material	Steel
Surface protection	zinc plated

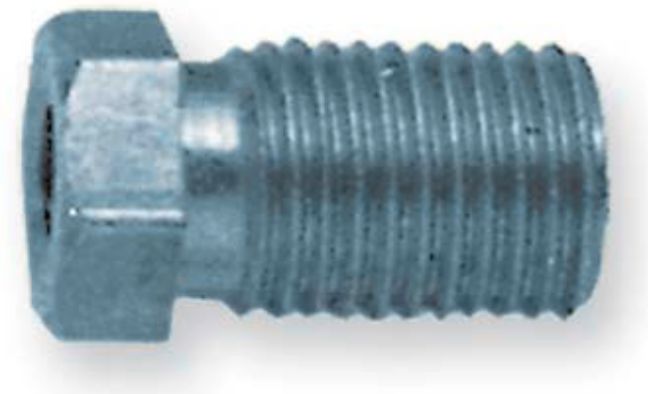

Title	Reference Vehicle Manufacturer	For Pipeline-Ø	Thread	Length	Wrench Width	PU Piece	Article No.
Brake Pipe Nipple BRT 009	Peugot Renault Talbot Volvo	4.75 mm	UNF 3/8 x 24	18 mm	10 mm	25	222461

AGR: 16.401

Brake Pipe Nipple BRT 010

Application Area

- DIN Flare F and double flaring

Technical Data

Flange Shape	DIN hem F, double hemming
Material	Steel
Surface protection	zinc plated



Title	Reference Vehicle Manufacturer	For Pipeline-Ø	Thread	Length	Wrench Width	PU Piece	Article No.
Brake Pipe Nipple BRT 010	Peugot Talbot Volvo	4.75 mm	UNF 1/2 x 20	18 mm	13 mm	25	222488

AGR: 16.401

INTERNAL/Approved (2019-03-22 22:27:27)

Brake Pipe Nipple BRT 011

Application Area

- DIN Flare F and double flaring

Technical Data

Flange Shape	DIN hem F, double hemming
Material	Steel
Surface protection	zinc plated



11

Title	Reference Vehicle Manufacturer	For Pipeline-Ø	Thread	Length	Wrench Width	PU Piece	Article No.
Brake Pipe Nipple BRT 011	Audi Daimler Benz Ford Saab Volvo VW	6 mm	M 12 x 1	18 mm	12 mm	25	222496

AGR: 16.400

Brake Pipe Nipple BRT 012

Application Area

- DIN Flare F and double flaring

Technical Data

Flange Shape	DIN hem F, double hemming
Material	Steel
Surface protection	zinc plated

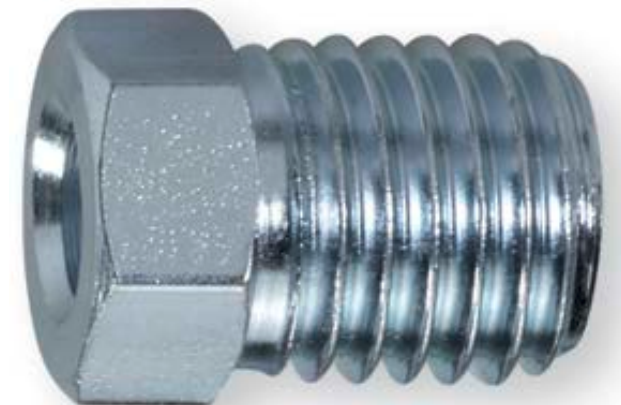

Title	Reference Vehicle Manufacturer	For Pipeline-Ø	Thread	Length	Wrench Width	PU Piece	Article No.
Brake Pipe Nipple BRT 012	Fiat Mazda	4.75 mm	M 10 x 1.25	14.2 mm	10 mm	25	222500

AGR: 16.400

INTERNAL/Approved (2019-03-22 22:27:34)

Brake line nipples and pipes

Connecting Piece BRT 013

Application Area

- DIN-Flare F and double flaring

Technical Data

Flange Shape	DIN hem F, double hemming
Material	Steel
Surface protection	zinc plated

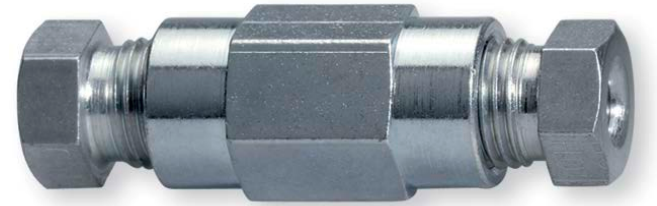

Title	Reference Vehicle Manufacturer	For Pipeline-Ø	Thread	Length	Wrench Width	PU Piece	Article No.
Connecting Piece BRT 013	Universal	4.75 mm	M 10 x 1	36 mm	11 mm	5	421006

AGR: 16.400

Brake Pipe Nipple BRT TX

Application Area

- DIN Flare F and double flaring

Technical Data

Material	Steel
Surface protection	zinc plated



Title	Reference Vehicle Manufacturer	For Pipeline-Ø	Thread	Length	Wrench Width	PU Piece	Article No.
Brake Pipe Nipple BRT TX	Daihatsu Honda Hyundai Isuzu Mazda Mitsubishi Nissan Opel / Vauxhall Suzuki Toyota VW	4.75 mm	M 10 x 1	18 mm	10 mm	25	020008

AGR: 16.400

Brake Bleeding Screw BRT 030

Technical Data

Material	Steel
Surface protection	zinc plated



11

Title	Reference Vehicle Manufacturer	Thread	Length	Wrench Width	PU Piece	Article No.
Brake Bleeding Screw BRT 030	Alfa Romeo	M 7 x 1	30.5 mm	7 mm	25	221694
	Audi					
	BMW					
	Citroen					
	DAF					
	Daihatsu					
	Fiat					
	Ford					
	Honda					
	Lancia					
	Mazda					
	Mercedes Benz					
	Mitsubishi					
	Peugot					
	Renault					
	Rover					
	Saab					
	Seat					
	Subaru					
	Suzuki					
Talbot						
Toyota						
Volvo						
VW						

AGR: 16.410

Spare Parts

	PU Piece	Article No.
Rubber Cap BRT 042	25	222186

INTERNAL/Approved (2019-03-22 22:27:45)

Brake Bleeding Screw BRT 031

Technical Data

Material	Steel
Surface protection	zinc plated



Title	Reference Vehicle Manufacturer	Thread	Length	Wrench Width	PU Piece	Article No.
Brake Bleeding Screw BRT 031	Alfa Romeo	M 7 x 1	38.3 mm	7 mm	25	221813
	Audi					
	BMW					
	Citroen					
	DAF					
	Daihatsu					
	Ford					
	Opel / Vauxhall					
	Peugot					
	Saab					
	Seat					
	Skoda					
	Subaru					
	Talbot					
	Toyota					
	Volvo					
VW						

AGR: 16.410

Spare Parts

	PU Piece	Article No.
Rubber Cap BRT 042	25	222186

Brake Bleeding Screw BRT 032

Technical Data

Material: Steel
 Surface protection: zinc plated



11

Title	Reference Vehicle Manufacturer	Thread	Length	Wrench Width	PU Piece	Article No.
Brake Bleeding Screw BRT 032	Alfa Romeo	M 10 x 1	30 mm	11 mm	25	221864
	Audi					
	Citroen					
	Fiat					
	Ford					
	Honda					
	Hyundai					
	IVECO					
	Jaguar					
	KIA					
	Mazda					
	Mercedes Benz					
	Mitsubishi					
	Nissan					
	Peugot					
	Renault					
	Rover					
	Saab					
Seat						
Skoda						
Toyota						
Volvo						
VW						

AGR: 16.410

Spare Parts

	PU Piece	Article No.
Rubber Cap BRT 042	25	222186

INTERNAL/Approved (2019-03-22 22:27:54)

Brake Bleeding Screw BRT 033

Technical Data

Material	Steel
Surface protection	zinc plated



Title	Reference Vehicle Manufacturer	Thread	Length	Wrench Width	PU Piece	Article No.
Brake Bleeding Screw BRT 033	Audi BMW Ford Mercedes Benz Saab Seat VW	M 6 x 1	29 mm	7 mm	25	222038

AGR: 16.410

Spare Parts

	PU Piece	Article No.
Rubber Cap BRT 042	25	222186

Brake Bleeding Screw BRT 034

Technical Data

Material	Steel
Surface protection	zinc plated



11

Title	Reference Vehicle Manufacturer	Thread	Length	Wrench Width	PU Piece	Article No.
Brake Bleeding Screw BRT 034	BMW	M 10 x 1	34.3 mm	10 mm	25	222054
	Daewoo					
	Daihatsu					
	Ford					
	Honda					
	Hyundai					
	Mercedes Benz					
	Mitsubishi					
	Nissan					
	Opel / Vauxhall					
	Peugot					
	Renault					
	Rover					
	Subaru					
	Suzuki					
Toyota						
Vanden-Plas						
VW						

AGR: 16.410

Spare Parts

	PU Piece	Article No.
Rubber Cap BRT 042	25	222186

INTERNAL/Approved (2019-03-22 22:28:02)

Brake Bleeding Screw BRT 035

Technical Data

Material	Steel
Surface protection	zinc plated



Title	Reference Vehicle Manufacturer	Thread	Length	Wrench Width	PU Piece	Article No.
Brake Bleeding Screw BRT 035	BMW Citroen Fiat Lancia Mercedes Benz Opel / Vauxhall Peugeot Renault Toyota Volvo	M 8 x 1.25	41.5 mm	9 mm	25	222100

AGR: 16.410

Spare Parts

	PU Piece	Article No.
Rubber Cap BRT 042	25	222186

Brake Bleeding Screw BRT 036

Technical Data

Material: Steel
 Surface protection: zinc plated



11

Title	Reference Vehicle Manufacturer	Thread	Length	Wrench Width	PU Piece	Article No.
Brake Bleeding Screw BRT 036	Alfa Romeo	M 8 x 1.25	32.4 mm	9 mm	25	222119
	Audi					
	BMW					
	Citroen					
	Fiat					
	Honda					
	Mercedes Benz					
	Opel / Vauxhall					
	Peugot					
	Renault					
	Saab					
	Seat					
	Skoda					
Volvo						
VW						

AGR: 16.410

Spare Parts

	PU Piece	Article No.
Rubber Cap BRT 042	25	222186

INTERNAL/Approved (2019-03-22 22:28:11)

Brake Bleeding Screw BRT 037

Technical Data

Material	Steel
Surface protection	zinc plated



Title	Reference Vehicle Manufacturer	Thread	Length	Wrench Width	PU Piece	Article No.
Brake Bleeding Screw BRT 037	KIA Mazda Mercedes Benz Opel / Vauxhall Saab	M 8 x 1	33.5 mm	9 mm	25	222127

AGR: 16.410

Spare Parts

	PU Piece	Article No.
Rubber Cap BRT 042	25	222186

Brake Bleeding Screw BRT 038

Technical Data

Material	Steel
Surface protection	zinc plated



11

Title	Reference Vehicle Manufacturer	Thread	Length	Wrench Width	PU Piece	Article No.
Brake Bleeding Screw BRT 038	Alfa Romeo	M 8 x 1.25	24.5 mm	8 mm	25	222135
	Citroen					
	Daewoo					
	Fiat					
	Ford					
	Honda					
	KIA					
	Lada					
	Lancia					
	Mercedes Benz					
	Mitsubishi					
	Nissan					
	Opel / Vauxhall					
	Peugot					
	Renault					
Seat						
Talbot						
Volvo						

AGR: 16.410

Spare Parts

	PU Piece	Article No.
Rubber Cap BRT 042	25	222186

INTERNAL/Approved (2019-03-22 22:28:19)

Brake line accessories

Brake Bleeding Screw BRT 039

11

Technical Data

Material	Steel
Surface protection	zinc plated



Title	Reference Vehicle Manufacturer	Thread	Length	Wrench Width	PU Piece	Article No.
Brake Bleeding Screw BRT 039	Alfa Romeo	M 7 x 1	26.2 mm	7 mm	25	222143
	BMW					
	Citroen					
	Dacia					
	Daihatsu					
	Fiat					
	Ford					
	Isuzu					
	Mazda					
	Mitsubishi					
	Nissan					
	Opel / Vauxhall					
	Peugot					
	Renault					
	Seat					
	Skoda					
Talbot						
Volvo						
VW						

AGR: 16.410

Spare Parts

	PU Piece	Article No.
Rubber Cap BRT 042	25	222186

Brake Bleeding Screw BRT 040

Technical Data

Material	Steel
Surface protection	zinc plated



11

Title	Reference Vehicle Manufacturer	Thread	Length	Wrench Width	PU Piece	Article No.
Brake Bleeding Screw BRT 040	Alfa Romeo	M 7 x 1	28.7 mm	7 mm	25	222151
	Citroen					
	Fiat					
	Ford					
	Isuzu					
	Lancia					
	Mazda					
	Mitsubishi					
	Nissan					
	Peugot					
	Renault					
	Talbot					
	Toyota					
Volvo						

AGR: 16.410

Spare Parts

	PU Piece	Article No.
Rubber Cap BRT 042	25	222186

Bleeder screw BRT 041

Hints

- suitable for vehicle type: Iveco, Volvo and Rover

Technical Data

Material	Steel
Surface protection	yellow zinc plated



Title	Reference Vehicle Manufacturer	Thread	Wrench Width	PU Piece	Article No.
BRT 041 1/4"X28 UNFX27.3 SW 8	IVECO	UNF 1/4 x 28	8 mm	25	222178
	Rover				
	Volvo				

AGR: 16.410

INTERNAL/Approved (2019-03-22 22:28:27)

Rubber Cap BRT 042



Application Area

- Protects the brake bleeding screw against pollution

Technical Data

Material	Rubber
----------	--------

Title	PU Piece	Article No.
Rubber Cap BRT 042	25	222186

AGR: 16.410

Tyre Filling Hose

Application Area

- Filling the tyres from the vehicle's compressed air system
- Can be used e.g. at a slow puncture

Characteristics

- Robust hose tissue

Processing Information

- Wing nut for connection to the four-circuit protection valve
Lever nipple to attach onto tire valve



Title	Length (m)	PU Piece	Article No.
Tyre Filling Hose	12 m	1	024177

AGR: 16.944

Tyre Repair Set for Cars/Motorcycles

- Angular punctures of up to 40 degrees can be repaired
- No curing period required after the repair
- Simple operation
- Repair is possible up a maximum speed code number W (up to 270 km/h)
- Tested by TÜV (German Association for Technical Inspection):
Endurance run and top speed : ECE R30 for all car tyres, ECE R75 for all motorcycles tyres, conforming §36 StVZO, directive 247

Application Area

- Repair of puncture damage in the tread area of tubeless diagonal or radial tyres of cars and motorcycles according to German law paragraph 36 StVZO (German Road Traffic Registration Regulation)

Processing Information

- Detailed manual is included in the set
- In order to establish the extent of the damage and to apply the liquid repair patch, each tyre must be removed from the rim
- In HR tyres, (up to 210 km/h admissible) max. 6 mm Ø tread damage use black plug
- In W tyres (up to 270 km/h admissible) max. 3 mm Ø
- tread damage use red plug
- With the red plug the red safety foil must firstly be removed

Hints

- Tyres older than 6 years cannot be repaired with this set.
- Damage which has been repaired by auxiliary equipment (i.e. spray) cannot be repaired
- Plugs can be stored for 3 years in a dry, cool and dark place
- Rubber solution and liquid patches may be stored in closed containers between 1 to 1.5 years



Title	PU Assortment	Article No.
Tyre Repair Set Cars/Motorcycles AGR: 16.020	1	159659

Scope Of Supply	Piece	Article No.
Massive Aluminum Grip	1	162588
Awl Short (Car) without Grip	1	162591
Pricking Awl	1	159666
Repair Patch 50 ml	1	159669
Rubber Solution Tube 25 ml	1	159668
(90108_16_25_AT01_RoteSchnurPkwMotorrad)	25	-
(90108_17_25_AT01_SchwarzeSchnurPkw)	25	-
Spare Parts	PU Piece	Article No.
Black Plug incl. liquid Repair Patch 50 ml	1	159661
Red Plug Car/Motorcycle incl. liquid Repair Patch 50 ml	1	162585

Tyre Repairing Set for Trucks

- Oblique punctures can be repaired up to 40 °
- No waiting periods after repair
- Easy to use and assemble
- With a maximum design speed not exceeding 40 km/h a repair can be carried out without mounting the tire from the rim
- Tested by TÜV (German Association for Technical Inspection):
Endurance and speed: ECE R54 for all passenger car tires, motorcycle tires for all ECE R75, complies with § 36 StVZO (German Road Traffic Registration Regulation), Directive 247



Application Area

- Repair of stab wounds in the tread of the wheel with tubeless radial tires, or diagonal tyres of cars and motorcycles according to § 36 StVZO (German Road Traffic Registration Regulation)

Processing Information

- Detailed instructions included in the set
- To determine the damage extent and for applying liquid patch, each tire must be removed from the rim (except for maximum design speed 40 km/h)

Hints

- Tires that are older than 6 years age cannot be repaired!
- Damage that was repaired by auxiliary equipment (e.g. spray) cannot be repaired!



Further tyre and brake service

- Plugs can be stored for 3 years in dry, cool and dark places.
- Rubber solution and liquid patches may be stored for in closed containers for 1 to 1.5 years

Title	PU Assortment	Article No.
Tyre Repairing Set for Trucks AGR: 16.020	1	159660
Scope Of Supply	Piece	Article No.
Massive Aluminum Grip	1	162588
Awl Long (Car) without Grip	1	162589
Pricking Awl	1	159666
Rubber Solution Tube 25 ml	1	159668
Accessories Available	PU Bottle	Article No.
UNIVERSAL CLEANER CAN 1L	1/12	014795
Spare Parts	PU Piece	Article No.
Black Plug Car/Motorcycle	1	159663

Tire nail repair set

- The reparation from the inside provides a maximum of reliability and safety
- The "teller" of the reparation body is cured-on at the inside and guarantees absolute tightness
- Intrusion of dirt and water into the inner wheel is prevented through the vulkanisation of the repair body
- Quick reinstallation of the wheel through an easy repair work

Application Area

- Repair of stab wounds in the running surface of tubeless cross-ply and radial tires of passenger cars, motorcycles and commercial vehicles

Processing Information

- The branch canal is being cleaned and roughened by the rotary cutters situated in the kit, afterwards the repair body is going to be high-strength processed with the supplied patching cement
- Detailed repair instructions included in the kit



Hints

- Trough the rolling out of the wheel after a flat tire until a standstill, the structure of the tire can be highly damaged. Only through a professional check it can be determined, which repair system should be used for fixing the tire. Therefore, for reasons of safety, the tire must be taken of the rim.

Scope Of Delivery

- Art.-Nr.: 119168: 20 pcs. repair plugs Ø 3 mm, 1 pc. rotary cutter Ø 3, 1 pc. patching cement
- Art.-Nr.: 119784: 25 pcs. repair plugs Ø 4.5 mm, 1 pc. rotary cutter Ø 4.5, 1 pc. patching cement
- Art.-Nr.: 120785: 24 pcs. repair plugs Ø 6 mm, 1 pc. rotary cutter Ø 6, 1 pc. patching cement

Title	Shaft Ø	PU Piece	Article No.
TYRE REPAIR SET NAIL CAR 3MM	3 mm	1	119168
TYRE REPAIR SET NAIL CAR 4,5MM	4.5 mm	1	120784
TYRE REPAIR SET NAIL CAR 6MM	6 mm	1	120785

AGR: 16.020

Knurl for wheel repair

Application Area

- Tool for pressing on the "disc" of the repair body of the wheel-nail repair set at the inner tire



Title	PU Piece	Article No.
KNURL TYREREPAIR 38X1,5MM	1	120786

AGR: 16.020

INTERNAL/Approved (2019-03-22 22:28:47)

11 **Tyre and Mounting Lever**

Application Area

- Passenger cars and light trucks

Characteristics

- Double-T profile for high stability, chrome-vanadium steel and chrome-plated surface



Title	Length	PU Piece	Article No.
Tire lifter HZ 650-20	500 mm	1	174548

AGR: 03.412

Wheel Cross Commercial Vehicle

Characteristics

- Forged arms and centerpiece, chrome-vanadium-steel, factory standard chromium-platted



Title	Output shape	Wrench Size 1	Wrench Size 2	Wrench Size 3	Wrench Size 4 Inch	Length	PU Piece	Article No.
CROSS RIME WRENCH 17X19X22X1/2	6KT	17 mm	19 mm	22 mm	1/2 "	420 mm	1	183774
WHEEL SPIDER WRENCH GOODS VEH	6KT	24 mm	27 mm	32 mm	3/4 "	750 mm	1	215635

AGR: 03.419

INTERNAL/Approved (2019-03-22 22:28:57)

Commercial Vehicle Lever Bar

Characteristics

- Impact resistant ergonomic plastic handle
- Continuous square-cut and special steel blade 16x16 mm with strong impact head for maximum strain
- Hardened and tempered, can be regrinded

Title	PU Piece	Article No.
SHAFT DRIVE NUT FOR VW/AUDI	1	020508

AGR: 03.419

Commercial Vehicle Lever Bar

Application Area

- Control the function of coupling plates - type 2
- Lever shaft seals from the wheel hub - type 3
- Mount wheels onto vehicles - type 2
- Control ball joints of the tie rod and handlebar
- Control the function of the silent bearing
- function of the wheel bearing at the front axle
- rubber bearing trailer
- Control the function of the cardan shaft - type 1

Characteristics

- Totally new pry bars, developed in order to meet the special demands of truck garages
- impact resistant ergonomic plastic handle, for use with two hands
- Continuous square-cut and special steel blade 16x16 mm with strong impact head for maximum strain
- Hardened and tempered, can be regrinded

Title	Length x width	PU Piece	Article No.
18 Wheels-Pry Bar	620 x 16 mm	1	161481*
18 Wheels-Pry Bar	620 x 36 mm	1	161480*

* = The delivery time is 21 days

AGR: 03.419



INTERNAL/Approved (2019-03-22 22:29:03)

Further tyre and brake service

HD Leaver 914 mm

- Continuous forged square steel
- Sharp cutting edge
- Tip angled for more leverage and applications
- Top can be sharpened
- Face behind handle
- High-quality plastic handle also to be used with both hands



Title	Length	PU Piece	Article No.
HD Leaver	914 mm	1	333645

AGR: 03.419

Tyre marker

Title	PU Sachet	Article No.
TYRE MARKER YELLOW BAG/25SET	1	160667

AGR: 16.090

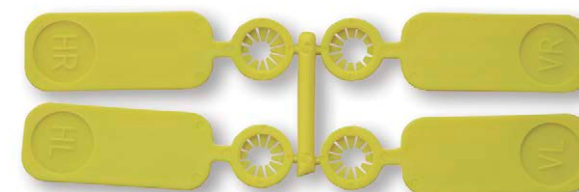

wheel nut bag

Characteristics

- 140 x 200 mm
- Nonwoven fabric

Title	PU Piece	Article No.
WEEL BOT BAG	1	188543

AGR: 16.990



Tyre Leaver Iron regular

Technical Data

Material Chrome steel



333714

333715

333716



185027

11

Title	Length	Weight	PU Piece	Article No.
Tyre Leaver Iron 240 mm	240 mm	254 g	1	333714
Tyre Leaver Iron 300 mm	300 mm	302 g	1	333715
Tyre Leaver Iron 500 mm	500 mm	720 g	1	333716
9080/4 TYRE LEVER L 600 STR	600 mm	950 g	1	185027

AGR: 03.404

Tire lever 650 mm offset style



Characteristics

- Surface : chrome plated.
- Length : 650 mm

Technical Data

Material Chrome steel

Title	Length	Weight	PU Piece	Article No.
Tire lever 650 mm offset style	650 mm	1300 g	1	243806

AGR: 03.404

Tire lever nylon overlay

- Nylon surface to avoid aluminium rims

Application Area

- For working on aluminium rims.

Technical Data

Material Chrome vanadium steel



Title	Length	Weight	PU Piece	Article No.
Tire lever nylon overlay	380 mm	500 g	1	243807
Tyre lever nylon overlay	500 mm	850 g	1	333717

AGR: 03.404

Spare Parts

	PU Amount	Article No.
Tyre Leaver Protection 380 mm	1	339084
Tyre Leaver Protection 500 mm	1	339083

Truck tire lever " Heavy Duty"

- Deliver with a pick and e lever end.

Application Area

- To loosen oruptake big tires.

Characteristics

- Surface : chrome plated.
- Lenght : 1370 mm.
- Ø : 25 mm.



Title	Ø	Length	Weight	PU Piece	Article No.
Truck tire lever " Heavy Duty" 1370 mm	25 mm	1370 mm	5200 g	1	243805

AGR: 03.404

Tyre Bead hold down

- Fast and damage-free mounting of tyres and rims
- Both hands free for further activities
- No overstraining of the tyre bead, the carcass and the rim
- Very robust handle
- The tyre bead hold-down device is universally applicable
- Can be used in conjunction with all tyre changers
- Ideal for the mounting of run-flat tires

Application Area

- The tyre bead hold-down device holds the tyre bead under the rim flange / drop centre when mounting the tyre.



Title	PU Piece	Article No.
Tyre Bead hold down AGR: 03.419	1	366686

Tyre Bead hold down Lever

- Fast and damage-free mounting of tyres and rims
- No overstraining of the tyre bead, the carcass and the rim
- Very robust handle
- The tyre bead hold-down device is universally applicable
- Can be used in conjunction with all tyre changers
- Ideal for the mounting of run-flat tires

Application Area

- The tyre bead hold-down device holds the tyre bead under the rim flange / drop centre when mounting the tyre.



Title	PU Piece	Article No.
Tyre Bead hold down lever AGR: 03.419	1	366687

Pliers for wheel bolt cover



- No damage to the protective cap or rim
- Quick and easy removal of the protective caps
- Due to the 2-component handle it fits comfortably in the hand
- Long, slender legs for safe gripping of deep-lying caps, such as ALU rims
- Notch at the tip to safely hold the caps
- Chrome Vanadium Steel

Application Area

- Remove the caps from wheel bolts

Technical Data

Grip Material 2 component handle

Title	Length	PU Piece	Article No.
Pliers for wheel bolt covers	250 mm	1	366677

AGR: 03.402

Lever for Rim Cover Remove and Mount

- Very thin cutting edge at the tip for easy access between hubcap and rim
- Non-destructive removal of the wheel cap
- Robust plastic handle
- Very good leverage effect
- Due to the applied rubber anvil, it can also be used very well for mounting the hubcap, protects the palms of the hands
- Fast and efficient work.

Application Area

- Special lever for loosening or mounting hubcaps



11

Title	Length	Width	PU Piece	Article No.
Lever for Rim Cover Remove and Mount	360 mm	25 mm	1	366679

AGR: 03.403

Lever for Rim Cover Protected

- The 2-component handle ensures that the lever lies securely and comfortably in the hand.
- Very thin cutting edge at the tip of the fork to get easily between rim and hubcap
- Rubberized lever knee to avoid damage to tyres or rim
- Also well suited for loosening panels in the vehicle interior, the paint is not scratched by the protection in the lever area.

Application Area

- Remove the rim cover



Title	Length	Width	Fork Opening	PU Piece	Article No.
Lever for Rim Cover Protected	305 mm	30 mm	15 - 7 mm	1	366678

AGR: 03.403

INTERNAL/Approved (2019-03-22 22:29:52)

Tyre Lever Run-Flat



- Movable plastic slider to protect the rim
- Very robust and resilient
- Rounded corners to avoid damage to the tyre
- Sturdy edge to grip safely under the bead

Application Area

- Especially for Run Flat tires

Technical Data

Material	Chrome vanadium steel
----------	-----------------------

Title	Length	Weight	PU Piece	Article No.
Tyre Lever Run-Flat	535 mm	971 g	1	366675

AGR: 03.404

Spare Parts

	PU Amount	Article No.
Tyre Leaver Protection for Run Flat	1	370385

Speedy Wheel with shank holding including 3 pads

- High robustness of the bell by the aluminum version
- High service life of the discs (for 100 cars)

Application Area

- Wheel hubs up to 60mm
- Quick and easy cleaning of the wheel hub

Scope Of Delivery

- Speedy Wheel shank holding including 3 pads



INTERNAL/Approved (2019-03-22 22:30:01)

Title	Diameter External	Internal Ø	Grain	Grain Fine Medium	PU Piece	Article No.
Speedy Wheel Set	160 mm	58 mm	P 10	Coarse	1	169908

AGR: 10.425

Spare Parts

Cleaning Pad Speedy Wheel

PU
Piece

Article No.

1 169909

Speedy Wheel Large

- High robustness of the bell by the aluminum version
- High service life of the discs (for 100 cars)

Application Area

- Vehicles with wheel hubs over 60 mm such as BMW, Ducato etc.
- Quick and easy cleaning of the wheel hub

Scope Of Delivery

- Speedy Wheel Large incl. 2 pads and 1 holder



Title	Diameter External	Internal Ø	Grain	Grain Fine Medium	PU Piece	Article No.
Cleaning Panel Speedy Wheel Large	-	-	-	-	1	171355
Speedy Wheel Large	200 mm	83 mm	P 10	Coarse	1	171145

AGR: 10.425

Scope Of Supply

	Amount	Article No.
Cleaning Panel Speedy Wheel Large	2	171355
Speedy Wheel Large	1	-

Speedy Wheel Bolt

- High robustness of the bell due to the aluminum version
- High service life of the disks (for approx. 100 cars)

Application Area

- Vehicles with bolts, such as Ford
- Quick and easy cleaning of the hub

Scope Of Delivery

- 2 x Reinigungsscheibenaufnahme
- 6 x Reinigungsscheiben 40 mm
- 6 x Reinigungsscheiben 50 mm



Ø 40 mm

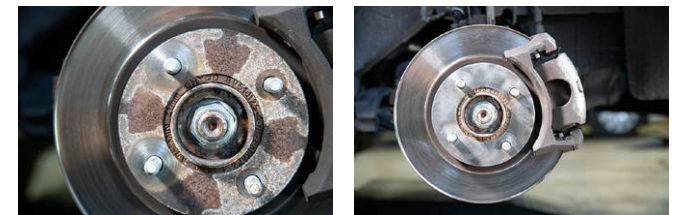

Ø 50 mm



Title	PU Piece	Article No.
Speedy Wheel Bolt	1	171146
AGR: 10.425		
Spare Parts	PU Piece	Article No.
Cleaning Disc Speedy Wheel Bolt Ø 4 cm	1	171353
Cleaning Disc Speedy Wheel Bolt, Large	1	171354

INTERNAL/Approved (2019-03-22 22:30:11)

Wheel hub cleaner 1/2" drive

11

- No residues, reduced dust generation, no flying sparks
- No time-consuming cleaning of the wire brush
- Easy replaceable cleaning disks and long life-time
- Drive with 1/2" impact wrench
- Aluminium-bell is hardened at the 1/2" section
- Also usable with a drilling machine with the help of an adapter

Application Area

- Professional tool for the rapid removal of rust and aluminium damage on contact areas of hubs, rims, brake drums, brake disks and so on

Hints

- Recommended by the DAIMLER AG + PORSCHE AG



Title	Height	PU Piece	Article No.
Wheel hub cleaner 1/2" drive	105 mm	1	216442
AGR: 10.425			
Accessories Available		PU Amount	Article No.
DRILL MACHINE ADAPTER 1/2"		1	216440
Spare Parts		PU Amount	Article No.
WHEEL HUB CLEANER DISC, 3PCS		1	216441

Cleaning disc for Wheel hub



11

Title	PU Piece	Article No.
WHEEL HUB CLEANER DISC, 3PCS AGR: 10.425	1	216441

Stehbolzencleaner

- Ideal for wet and dry cleaning
- Unaided re-sharpening of the brush
- For the cleaning of contact areas around studs
- Cleaning of sealing surfaces
- Derusting of metals
- No damaging of the studs or the thread
- Brush with a special granulate for quick cleaning



Application Area

- Cleaning of the stud on the wheel receiver

Title	PU Piece	Article No.
Stehbolzencleaner AGR: 10.425	1	216439
Spare Parts	PU Amount	Article No.
STUD BOLT CLEANER SPARE BRUSH	1	216438

INTERNAL/Approved (2019-03-22 22:30:23)

Brake service device BSG 5 II

Title	PU Piece	Article No.
BRAKE SERVICE DEVICE VARIO 5II	1	147203
AGR: 08.005		
Scope Of Supply	Amount	Article No.
BGE 01 COLL.BOTTLE 1 LTR.	1	107105
BGE 20 CONNECTOR COVER	1	107086
Spare Parts	PU Amount	Article No.
FILLING HOSE 3,5M W.COUPLER	1	047530



brake maintenance device BEG 210 E

Title	PU Piece	Article No.
BEG 210E BRAKE VENTING DEV	1	112179
AGR: 08.005		
Spare Parts	PU Amount	Article No.
FILLING HOSE 3,5M W.COUPLER	1	047530



Brake maintenance device BEG 210 E

-
-
-
-

Application Area

- Application
 BS37: Chrysler, Ford, Nissan, Subaru
 E 20: VW Scharan, Ford Galaxy, Seat Alhambra, Renault Espace, Peugeot 806
 G 75: Isuzu, Mitsubishi, Proton, Subaru, Suzuki, Volvo
 U 90 K: Universally applicable for different vehicles with a chain fastening

Title	PU Piece	Article No.
UNIVERSAL ADAPTER SET AGR: 08.007	1	147604



BGE Connection cover



INTERNAL/Approved (2019-03-22 22:30:39)

11



107086

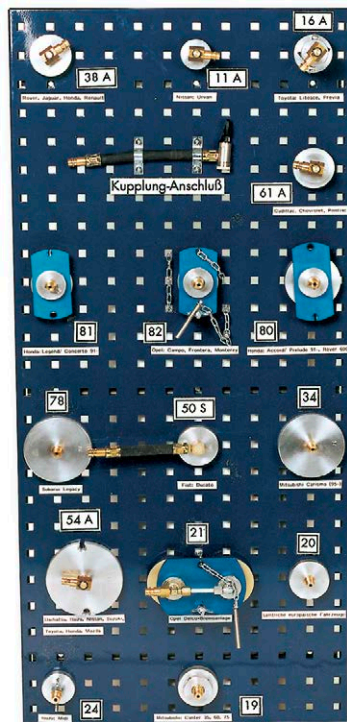

107090
01

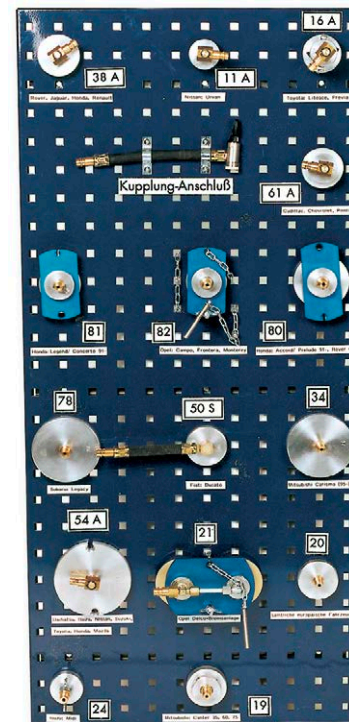

135706
02

No.	Title	PU Piece	Article No.
	Ancillary cover	1	107086
01	BGE 55A CONNECTOR COVER	1	107090*
02	CONNECTOR COVER NO. 38-A	1	135706*

* = The delivery time is 28 days

AGR: 08.007

Accessories Available

	PU Piece	Article No.
B 1520 PVC-AUFFANGFLASCHE	1	198331

INTERNAL/Approved (2019-03-22 22:30:45)

PVC Collecting bottle

Title	PU Piece	Article No.
B 1520 PVC-AUFFANGFLASCHE	1	198331
Intercepting Bottle	1	107105

AGR: 08.007



Membrane

11

Title	PU Piece	Article No.
Membrane	1	400297*

* = The delivery time is 56 days
 AGR: 08.007

Spare part hose for vacuum BB

Title	PU Piece	Article No.
Spare part hose for vacuum BB	1	213444

AGR: 08.007



Y hose for brake bender

Application Area

- Hose suitable for the brake bleeder to purge simultaneous dual-piston calipers.

Title	PU Piece	Article No.
Double pipe output to brake bleeder	1	213442

AGR: 08.007



"Brake fluid extractor "Brake Bleeder" 800 ml"

- Comes with a nurse 600 MI with locking clips suitable for all types of reservoir master cylinder with height adjustment liquid for automatic refill tank for a brake bleed without level control during the operation
- Nanny 600 MI with stop valve to prevent flow of liquid when removing the nurse at the end of purge.
- Small footprint for easy use near wheelhouse.
- Transparent suction hose for a good view of the liquid used with quick coupling and rubber coupling for adaptation purges brake.
- Ability to hold the bleeding device thanks to its hook.
- With lock the trigger in order to allow operation type handsfree.

Application Area

- To purge the suction of hydraulic braking systems.

Characteristics

- Tank trap brake: 800 MI.
- Food: 1/4 female.
- Quick coupling for changing the drain pipe connection.
- Length of suction tube: 0.85 mm

Processing Information

- Comes seamless connection to the compressed air system of the workshop.

Title	PU Piece	Article No.
Vacuum brake bleeder 800 ml	1	213443
AGR: 08.007		
Accessories Available	PU Amount	Article No.
FLUID ECAVUATION TUBE	1	215411
Double pipe output to brake bleeder	1	213442
Spare Parts	PU Amount	Article No.
BOTTLE O-RING BRAKE BLEE.800	1	244210
SERVICE KIT BRAKE BLEE. 800	1	244207
Spare part hose for vacum BB	1	213444

INTERNAL/Approved (2019-03-22 22:31:10)

Filler dispenser 1500 ML

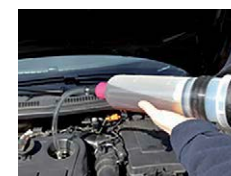

Title	Capacity	Ø	Length	PU Piece	Article No.
FILLER DISPENSER 200 ML	0.2 l	47 mm	280 mm	1	208125

AGR: 04.818

Brake Ventilation Socket

- Absolute clean working without lackages

Application Area

- Without the disassembly and assembly of the rear wheels
- Time saving of 40 time units according to VW-work instructions for dissassembly and the assembly of the wheels
- No retightening of the wheels with aluminium rims

Hints

- Supplied silicone tube and adapter nipple which is uitable for almost all collecting vessels

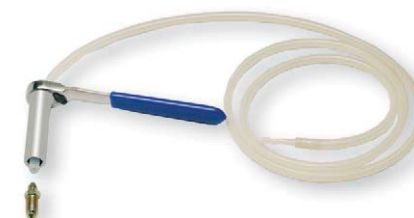

Title	PU Piece	Article No.
BRAKE VENTILATION SOCKET VAG	1	014081

AGR: 03.419

Brake Bleeder Wrench Set

- Clean and quick bleeding brakes clutch
- Bleeder wrench and hose holder in one piece
- Solve simple and close the bleeder
- Key easy to implement on the nut and through the 12-point nut suitable for hard to reach places
- Special seal in the nut ensures Airtight Connection to the breather hose and prevents Penetration of external air into the system
- Safety valve in the breather prevents the back gutters old brake fluid, avoiding air entrapment
- Color coding allows easy retrieval of the correct size

Application Area

- Venting of hydraulic brake and clutch systems



11

Title	PU Piece	Article No.
Brake Bleeder Set	1	245735
AGR: 03.401		
Scope Of Supply	Piece	Article No.
Brake Bleeder Wrench 8 mm	1	245734
Brake Bleeder Wrench 10 mm	1	245733
Brake Bleeder Wrench 11 mm	1	245732
Brake Bleeder Hose	1	245608

11

Brake Piston Reset Tool Kit

- Extensive range offers wide scope for all popular vehicles
- Clear arrangement in the case

Application Area

- Resetting (pressing and rotating) in brake pistons floating caliper systems with or without a hand brake locking device

Title	PU Set	Article No.
Brake Piston Reset Tool Kit 18-parts AGR: 03.401	1	005635
Accessories Available	PU Piece	Article No.
ADAPTER BRAKE PISTON VW/AUDI	1	139900



Universal brake piston reseter L/R

- With innovative adjustable 2- and 3 Pin Universal Brake piston adapter
- Ideally suited for turning back (push and turn) the Brake piston at floating calliper systems with or without brake-locking device
- With 2-way spindle - by reconnecting with left- and right-hand thread
- Low effort due to spindle drive
- Allows centered resetting of the brake piston without canting
- No damage to seals, pistons and piston bores in the caliper as misappropriation others Tools deleted
- Spindle with universal square drive
- insert made of high quality foam
- For nearly 98% of the vehicles on the European Markt applicable
- No more searching for the correct adapter. Time and money saving

Application Area

- Reset the brake piston by consistent Rotary and rotary motion to floating Calliper systems with or without brake-locking device
- If during maintenance work and replace the brake pads required to the brake piston into the caliper in bringing the starting position



Title	PU Piece	Article No.
Universal Brake Piston reseter L/R	1	245086

AGR: 03.401

Scope Of Supply	Piece	Article No.
Universal 2/3 Pin Disc	1	245087
Universal Brake Piston Spindle L/R	1	245085
Hold Back Plate	1	245053

INTERNAL/Approved (2019-03-22 22:31:38)

Universal Brake Piston Reset Disc

11

Title	PU Piece	Article No.
Universal Brake Piston Reset Disc 2 Pin	1	219480
Universal Brake Piston Reset Disc 3 Pin	1	219481

AGR: 03.401



Pneumatic Brake Piston Return Set

- Universal kit for turning and pressing brake pistons on almost all cars
- Innovative drive in the form of a compressed air spindle enables a very fast and convenient working
- The rotational movement (left and right) can be easily adjusted by hand and with a minimum effort
- The feed is pneumatic, be different slopes in the threads automatically compensated

Application Area

- Resetting (pressing and rotating) in brake pistons floating caliper
- systems with or without a hand brake locking device



Title	PU Piece	Article No.
AIRTYPE UNIVERSAL CALIPER RESETER KIT	1	051510

AGR: 03.401

Scope Of Supply	Piece	Article No.
AP-BACKE PISTON ADJUSTER	1	056260

Accessories Available	PU Piece	Article No.
ADAPTER BRAKE PISTON VW/AUDI	1	139900

Brake Piston reset ratchet

Title	PU Piece	Article No.
Brake Piston reset ratchet	1	219484

AGR: 03.401

Brake Pipe Bender

- With this brake pipe bender the brake pipes can be bent on the vehicle as well as in a dismantled state
- Due to the attached strap the brake pipe bender can be fixed in a vice

Application Area

- For precise bending of brake pipes on vehicles or in a dismantled state

Hints

- For the bending of brake pipes with a diameter of 4.75 and 6 mm
- Only suitable for copper/nickel brake pipes



Title	PU Piece	Article No.
463006 BRAKE PIPE BENDER	1	043523

AGR: 03.419

Reversible Knife positive

11

Title	PU Piece	Article No.
REV.KNIFE FOR DL 8600/8700 AGR: 03.419	1	864907



Brake Pipe flaring

- Geometrical accurate flanging according to DIN 74234
- Cam mechanic
- For copper, steel and aluminium pipes up to 1 mm wall thickness
- Damage free clamping, even of plastic-coated brake pipes, due to a new type of clamping jaws

Application Area

- For pipeline-Ø 4.75 and 6 mm
- For stationary use

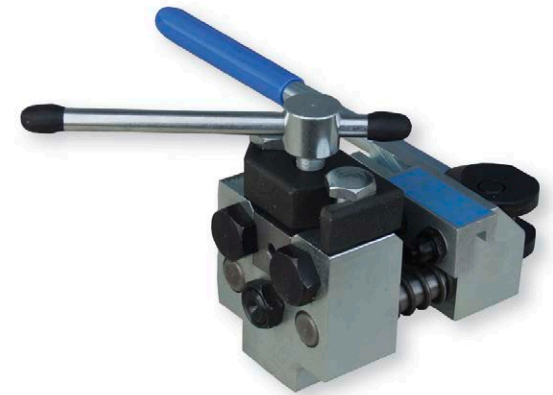

11

Title	PU Piece	Article No.
FLANGE BUILDER 463001	1	060717

AGR: 03.419

Universal Brake Line Flaring Tool

- Very suitable for the direct application of brake and hydraulic lines on the vehicle
- For the thin-walled steel, aluminium and copper lines (metric and inch)
- Production of convex and double flangings (according to DIN/SAE)
- Quick and precise results because of straight flanging movements (not turning), therefore no breakup of lines during the flanging process
- No damaging of coated lines

Application Area

- Professional flanging of brake and hydraulic lines with an diameter of the lines of 4,75 mm, 5,0 mm and 6,0 mm
- For steel, aluminium and copper lines
- Suitable for the direct application to the vehicle



Title	PU Piece	Article No.
UNI. DOUBLE CRIMPER IM CASE	1	109728
AGR: 03.401		
Scope Of Supply	Piece	Article No.
CLAMPING JAW SET 4,75MM 3/16"	1	213635
CLAMPING JAW SET 5MM	1	213634
CLAMPING JAW SET 6MM	1	213636
FLARING 4,75, 5,0 6,0 90° SAE	1	213637
FLARING 4,75-5,0MM DIN	1	213632
FLARING 4,75-5,0MM SAE	1	213633
FLARING 6,0MM DIN	1	213629
FLARING 6,0MM SAE	1	213628
(868877_11_1_AT01_Grundgert)	1	-
HYDRAULIC SPINDLE F 109728	1	187187
(868877_13_1_AT01_Schnellwechselhalterung)	1	-

Hydraulic device to trim the brake lines

- Fast and precise work results movement by straight cone, hence no twisting the brake line
- For the production of convex and double flaring
- No breaking of the line when hemming
- Light and handy with hydraulic pressure spindle
- No damage to coated lines

Application Area

- Craftsmanship beading of brake and hydraulic lines with a line Ø 4.75 mm, 5.0 mm and 6.0 mm
- For steel, aluminum and copper cables
- Suitable for direct use on the vehicle

Hints

- Spare parts for predecessor model 109728 type: Hydraulic spindle type 187187



Title	PU Piece	Article No.
HYDRAULIC FLARING TOOL	1	184085
AGR: 03.401		
Scope Of Supply	Piece	Article No.
CLAMPING JAW SET 4,75MM 3/16"	1	213635
CLAMPING JAW SET 5MM	1	213634
CLAMPING JAW SET 6MM	1	213636
FLARING 4,75-5,0MM DIN	1	213632
FLARING 6,0MM DIN	1	213629
FLARING 4,75-5,0MM SAE	1	213633
FLARING 6,0MM SAE	1	213628
FLARING 4,75, 5,0 6,0 90° SAE	1	213637

Tire tread cutter Rillfit

- The lifetime can be significantly enhanced through the recutting of cuttable (" regroovable") truck and bus tires. A new cuttable (" regroovable") commercial vehicle tire can be recutted up to two times in full profile depth
- Compatible with RILLCUT-cutter
- Hightech transformer with an overheat protection which ensures a safe and quick non-stop cutting
- Waterproof transformer housing with a temperature pre-selection and a twistable stepping switch
- Super flexible connecting cable
- Ergonomic cut grip
- TÜV-certified

Application Area

- Cutting of profile slots on rubber tires



Title	PU Piece	Article No.
TYRE PROFILE-CUTTER NUT.FIT AGR: 16.020	1	160040

Profi Cutter Knife round

- Guarantees correct temperature and a perfect spippage of the cutters

Application Area

- The regrooving blades are used with an electric tire sculptor.
- The choice of the blade is a function of the profile of the tire and the remaining tread depth.
- When regrooving operation of Manufacturers (AFNOR 12-741) must be met before any regrooving operation (depth, width, blade type).
- The adjustment of the heating is done according to the selected type of blade.

Characteristics

- Sculptor rounded blades strengthened.



Further tyre and brake service

- The dimension of the blade varies depending on the width and the desired regrooving depth.

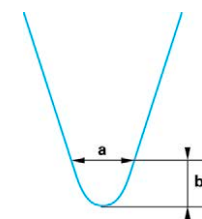
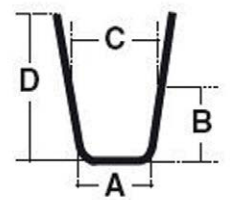
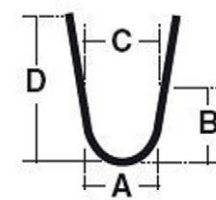
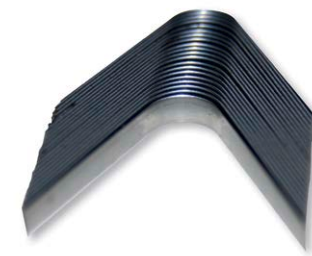
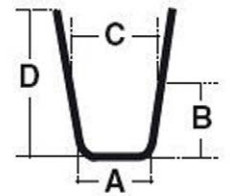
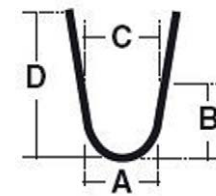

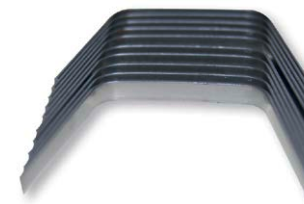

Title	Diameter	Shaft Ø	Width, Min. Or Single Value	Length	PU Amount	Article No.
ROUND BLADE R1	3 mm	7 mm	21 mm	5 mm	20	132039
PROF.CUTT.KNIFE RND	6 mm	10 mm	23 mm	15 mm	1/20	160013
PROF.CUTT.KNIFE ANG	7 mm	10 mm	22 mm	10 mm	20	160014
PROF.CUT.KNIFE RND R4 16MM	8 mm	12 mm	25 mm	16 mm	20	170356
PROF.CUTT.KNIFE ANG	9 mm	12 mm	24 mm	13 mm	20	129760
PROF.CUTT.KNIFE LRG ANG	23 mm	12 mm	24 mm	28 mm	1/10	160015

AGR: 16.020